

# MY PEUGEOT 2008

HANDBOOK



Download on the  
App Store

GET IT ON  
Google Play



PEUGEOT

## Driving recommendations

- ▶ Observe the driving regulations and remain vigilant whatever the traffic conditions.
- ▶ Monitor your environment and keep your hands on the wheel to be able to react to anything that may happen any time.
- ▶ Drive smoothly, anticipate the need for braking and maintain a longer safety distance, especially in bad weather.
- ▶ Stop the vehicle to carry out operations that require close attention (such as adjustments).
- ▶ During long trips, take a break every two hours.

### Important!

**!** **Never leave the engine running in a closed space without sufficient ventilation.** Internal combustion engines emit toxic exhaust gases such as carbon monoxide. Danger of poisoning and death!

**!** In very severe wintry conditions (temperature below -23°C), let the engine run for 4 minutes before moving off, to ensure the correct operation and durability of the mechanical components of your vehicle (engine and gearbox).

**!** **Never drive with the parking brake applied.** Risk of overheating and damaging the braking system!

**!** **Do not park the vehicle or leave the engine running on a flammable surface (e.g. dry grass, dead leaves).** The vehicle exhaust system is very hot, even several minutes after the engine stops. Risk of fire!

**!** **Never leave a vehicle unattended with the engine running.** If you have to leave your vehicle with the engine running, apply the parking brake and put the gearbox or drive selector into neutral or position **N** or **P** (depending on version).

**!** **Never leave children inside the vehicle unsupervised.**

### On flooded roads

We strongly advise against driving on flooded roads, as this could cause serious damage to the engine or gearbox, as well as to the electrical systems of your vehicle.

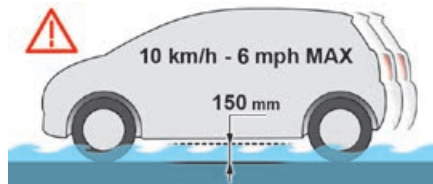

If you are obliged to drive on a flooded road:

- ▶ check that the depth of water does not exceed 15 cm, taking account of waves that might be generated by other users,
  - ▶ deactivate the Stop & Start function,
  - ▶ drive as slowly as possible without stalling. In all cases, do not exceed 6 mph (10 km/h),
  - ▶ do not stop and do not switch off the engine.
- On leaving the flooded road, as soon as safety conditions allow, make several light brake applications to dry the brake discs and pads. If in doubt about the state of your vehicle, contact a PEUGEOT dealer or a qualified workshop.

### Noise (Electric)

#### On the outside

Due to the vehicle's quiet operation when driving, the driver should pay particular attention. At speeds of up to 19 mph (30 km/h), the pedestrian horn warns other road users of the vehicle's presence.

#### **i** **Cooling the traction battery**

The cooling fan comes on during charging to cool the on-board charger and the traction battery.

#### On the inside

During use, you may hear certain perfectly normal noises specific to electric vehicles, such as:

- Traction battery relay when starting.

- Vacuum pump when braking.
- Vehicle tyres or aerodynamics when driving.
- Jolting and knocking noise during hill starts.

## Towing

**!** Driving with a trailer places greater demands on the towing vehicle and particular care must be taken.

**i** Do not exceed the maximum towable weights.

**At altitude:** reduce the maximum load by 10% per 1,000 metres of altitude; the lower air density at high altitudes decreases engine performance.

**!** **New vehicle:** do not tow a trailer until the vehicle has driven at least 620 miles (1,000 kilometres).

**i** If the outside temperature is high, let the engine idle for 1 to 2 minutes after the vehicle comes to a stop, to help it to cool.

## Before setting off

### Nose weight

► Distribute the load in the trailer so that the heaviest items are as close as possible to the axle and the nose weight (at the point where it

joins your vehicle) approaches the maximum permitted without exceeding it.

### Tyres

► Check the tyre pressures of the towing vehicle and of the trailer, observing the recommended pressures.

### Lighting

► Check the electrical signalling on the trailer and the headlamp beam height of your vehicle.

**i** If a genuine PEUGEOT towing device is used, the rear parking sensors will be deactivated automatically to avoid the audible signal.

## When driving

### Cooling

Towing a trailer uphill causes the coolant temperature to increase. The maximum towable load depends on the gradient and the exterior temperature. The fan's cooling capacity does not increase with engine speed.

► Reduce speed and lower the engine speed to limit heating up.

In all cases, pay attention to the coolant temperature.



If this warning lamp and the **STOP** warning lamp come on, stop the vehicle and switch off the engine as soon as possible.

## Brakes

Braking distances are increased when towing a trailer. To avoid overheating the brakes, the use of engine braking is recommended.

### Side wind

Bear in mind that the vehicle will be more susceptible to wind when towing.

## Anti-theft protection

### Electronic immobiliser

The keys include an electronic engine immobiliser system, with a code that must be recognised in order for starting to be possible. If the system malfunctions, indicated by the display of a message, the engine will not start. Contact a PEUGEOT dealer.

## Starting / Switching off the engine with the key

### Key ignition switch

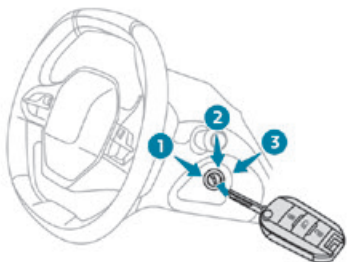

It has 3 positions:

- **1. Stop:** inserting and removing the key, steering column locked.
- **2. Ignition:** steering column unlocked, ignition on, Diesel preheating, engine running.
- **3. Starting.**

**i** Avoid attaching heavy objects to the key or the remote control. It would weigh down on its shaft in the ignition switch and could cause a malfunction.

### Ignition on position

It allows the use of the vehicle's electric equipment or portable devices to be charged.

Once the state of charge of the battery drops to the reserve level, the system switches to energy economy mode : the power supply is cut off automatically to preserve the remaining battery charge.

### Starting the engine

With the parking brake applied:

- ▶ With a **manual gearbox**, place the gear lever in neutral then fully depress the clutch pedal.
- ▶ With an **automatic gearbox**, place the gear selector in mode **N** or **P** then fully depress the brake pedal.
- ▶ Insert the key into the ignition switch; the system recognises the code.
- ▶ Unlock the steering column by simultaneously turning the steering wheel and the key.

**i** In certain cases, you may have to apply significant force to move the steering wheel (wheels on full lock, for example).

- ▶ With a **petrol engine**, operate the starter motor by turning the key to position **3** without pressing the accelerator pedal, until the engine starts. As soon as the engine starts, release the key.

**i** With **petrol engines**, after a cold start, preheating the catalytic converter can cause noticeable engine vibrations for anything up to 2 minutes while stationary with the engine running (accelerated idle speed).

- ▶ With a **Diesel engine**, turn the key to position **2**, ignition on, to operate the engine preheating system.

 Wait until this warning lamp goes off in the instrument panel, then operate the starter motor by turning the key to position **3** without pressing the accelerator pedal, until the engine starts. As soon as the engine starts, release the key.

**i** In wintry conditions, the warning lamp may stay on for a longer period. When the engine is hot, the warning lamp does not come on.

**!** If the engine does not start straight away, switch off the ignition. Wait a few seconds before operating the starter motor again. If the engine does not start after a few attempts, do not keep trying - risk of damaging the starter motor and the engine. Contact a PEUGEOT dealer or a qualified workshop.

**i** In mild conditions, do not leave the engine to warm up while stationary, but move off straight away and drive at moderate speed.

### Switching off the engine

- ▶ Immobilise the vehicle.

- ▶ With the engine at idle, turn the key to position 1.
- ▶ Remove the key from the ignition switch.
- ▶ To lock the steering column, turn the steering wheel until it locks.

**I** To facilitate unlocking of the steering column, it is recommended that the wheels be returned to the straight ahead position before switching off the engine.

**!** Never switch off the ignition before the complete immobilisation of the vehicle. With the engine off, the braking and steering assistance systems are also cut off - risk of loss of control of the vehicle!

**I** Check that the parking brake is correctly applied, particularly on sloping ground. When leaving the vehicle, keep the key in your possession and lock the vehicle.

## Energy economy mode

After the engine has stopped (position 1. **Stop**), for a maximum combined duration of about thirty minutes, you can still use functions such as the audio and telematics system, courtesy lamps, windscreen wipers, dipped beam headlamps, etc.

**I** For more information on **Energy economy mode**, refer to the corresponding section.

### **I** Key left in

When opening the driver's door, an alert message is displayed, accompanied by an audible signal, to remind you that the key is still in the ignition switch at position 1 (**Stop**). If the key has been left in the ignition switch at position 2 (**Ignition on**), the ignition will be switched off automatically after one hour. To switch the ignition back on, turn the key to position 1 (**Stop**), then back to position 2 (**Ignition on**).

## Starting / Switching off the engine with Keyless Entry and Starting

**I** The electronic key must be present in the passenger compartment.

For versions equipped with Proximity Keyless Entry and Starting, the electronic key is also detected in the boot.

If it is not detected, a message is displayed. Move the electronic key so that the engine can be started or switched off.

If there is still a problem, refer to the "Key not detected - Back-up starting or Back-up switch-off" section.

## Starting



- ▶ With a **manual gearbox**, place the gear lever in neutral and fully depress the clutch pedal.
- ▶ With an **automatic gearbox**, select mode **P** or **N** and press the brake pedal.
- ▶ Press the "**START/STOP**" button while maintaining pressure on the pedal until the engine starts.

For **Diesel engines**, when the temperature is below zero and/or the engine is cold, starting will only occur once the preheating warning lamp is off.

**!** If this warning lamp comes on after pressing the "**START/STOP**" button:

- ▶ Keep the pedal fully depressed and do not press the "**START/STOP**" button again until the engine is running.

If one of the starting conditions is not met, a message is displayed.

In some circumstances, a message indicates that it is necessary to turn the steering wheel

while pressing the **"START/STOP"** button to assist unlocking of the steering column.

**i** With **petrol engines**, after a cold start, preheating the catalytic converter can cause noticeable engine vibrations for anything up to 2 minutes while stationary with the engine running (accelerated idle speed).

**i** If the engine stalls, release the clutch pedal and fully depress it again, the engine will restart automatically.

## Switching off

- ▶ Immobilise the vehicle, with the engine at idle.
- ▶ With a **manual gearbox**, ideally put the gear lever into neutral.
- ▶ With an **automatic gearbox**, ideally select mode **P** or **N**.
- ▶ Press the **"START/STOP"** button.

In some circumstances, it is necessary to turn the steering wheel to lock the steering column.

**i** If the vehicle is not immobilised, the engine will not switch off.

**!** With the engine off, the braking and steering assistance systems are also cut off - risk of loss of control of the vehicle!

**!** Never leave your vehicle with the electronic key still inside.

## Starting/Switching off the electric motor

### Starting

The drive selector must be in mode **P**.

- ▶ Fully depress the brake pedal and briefly press the **"START/STOP"** button.
  - ▶ Keep your foot on the brake pedal until the **READY** indicator lamp comes on and an audible signal is emitted, indicating that the vehicle is ready to drive.
  - ▶ With your foot on the brake, press the **"Unlock"** button and select mode **D/B** or **R**.
  - ▶ Release the brake pedal, then accelerate.
- On starting, the instrument panel lights up and the power indicator needle or cursor moves to the "neutral" position. The steering column automatically unlocks (you may hear a sound and feel the steering wheel move).

### Switching off

- ▶ Press the **"START/STOP"** button.
- Before exiting the vehicle, check that:
- The drive selector is in mode **P**.
  - The **READY** indicator lamp is off.

**i** If the driver's door is opened while the required conditions for stopping are not satisfied, an audible signal is emitted,

accompanied by the display of a warning message.

## Switching on the ignition without starting the engine



With the electronic key in the passenger compartment, pressing the **"START/STOP"** button, **without pressing any of the pedals**, allows the ignition to be switched on without starting the engine.

- ▶ Press this button **again** to switch off the ignition and allow the vehicle to be locked.

## Key not detected

### Back-up starting

A back-up reader is fitted to the steering column, to enable the engine to be started if the system fails to detect the key in the recognition zone, or if the battery in the electronic key is discharged.

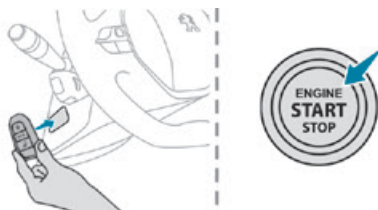

- ▶ Place and hold the remote control against the reader.
- ▶ **With a manual gearbox**, place the gear lever in neutral, then fully depress the clutch pedal.
- ▶ **With an automatic gearbox or a drive selector**, select mode **P**, then fully depress the brake pedal.
- ▶ Press the "**START/STOP**" button. The engine starts.

### Back-up switch-off



If the electronic key is not detected or is no longer in the recognition zone, a message

appears in the instrument panel when closing a door or trying to switch off the engine.

- ▶ To confirm the instruction to switch off the engine, press the "**START/STOP**" button for approximately 5 seconds.

In the event of a fault with the electronic key, contact a PEUGEOT dealer or a qualified workshop.

### Emergency switch-off

In the event of an emergency only, the engine can be switched off without conditions (even when driving).

- ▶ Press the "**START/STOP**" button for about 5 seconds.

In this case, the steering column locks as soon as the vehicle stops.

### Manual parking brake

#### Release



- ▶ Pull the parking brake lever up slightly, press the release button, then lower the lever fully.



When driving the vehicle, if this warning lamp and the **STOP** warning lamp come on, accompanied by an audible signal and the display of a message, this means that the parking brake is still applied or has not been fully released.

### Application

- ▶ Pull the parking brake lever up to immobilise the vehicle.



When parking on a slope, turn the wheels against the kerb, apply the parking brake, engage a gear and switch off the ignition.

### Electric parking brake

In automatic mode, this system applies the parking brake when the engine is switched off and releases it when the vehicle moves off.

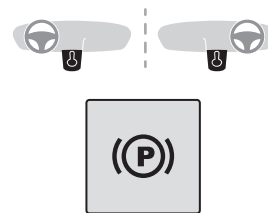

At any time, with the engine running:

- ▶ to apply the parking brake, **briefly** pull the control lever;

- ▶ to release it, briefly **push** the control lever while pressing the brake pedal.  
Automatic mode is activated by default.

## Indicator lamp

 This indicator lamp comes on on the instrument panel and on the control lever to confirm the application of the parking brake, accompanied by the display of the message "Parking brake applied".

The indicator lamp goes out to confirm the release of the parking brake, accompanied by the display of the message "Parking brake released".

The indicator lamp flashes in response to a manual request to apply or release the brake.

 In the event of a battery failure, the electric parking brake will not operate.

As a safety measure, with a manual gearbox, if the parking brake is not applied, immobilise the vehicle by engaging a gear.

As a safety measure, with an automatic gearbox or drive selector, if the parking brake is not applied, immobilise the vehicle by placing the supplied chock against one of the wheels.

Contact a PEUGEOT dealer or a qualified workshop.

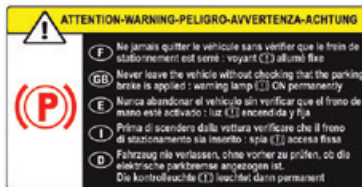

 Before leaving the vehicle, check that the parking brake is applied: the indicator lamps on the instrument panel and the control lever must be on fixed.

If the parking brake is not applied, there is an audible signal and a message is displayed on opening the driver's door.

 Never leave a child alone inside the vehicle, as they could release the parking brake.

 **When the vehicle is parked: on a steep slope, heavily loaded or during towing**

With a manual gearbox, turn the wheels toward the pavement and engage a gear.

With an automatic gearbox or a drive selector, turn the wheels toward the pavement and select mode **P**.

When towing, the vehicle is approved for parking on slopes of up to 12%.

## Manual operation

### Manual release

With the ignition on or engine running:

- ▶ Depress the brake pedal.
- ▶ While maintaining pressure on the brake pedal, briefly push the control lever.

 If you push the control lever without pressing the brake pedal, the parking brake is not released and a message is displayed.

### Manual application

With the vehicle stationary:

- ▶ Pull briefly on the control lever.

The control lever indicator lamp flashes to confirm the application request.

## Automatic operation

### Automatic release

First ensure that the engine is running and the driver's door is properly closed.

The electric parking brake **gradually releases automatically as the vehicle moves off**.

#### With a manual gearbox

- ▶ Fully depress the clutch pedal and engage first gear or reverse.
- ▶ Depress the accelerator pedal and release the clutch pedal.

#### With an automatic gearbox



- ▶ Depress the brake pedal.
- ▶ Select mode **D**, **M** or **R**.
- ▶ Release the brake pedal and depress the accelerator pedal.

#### With a drive selector

- ▶ Depress the brake pedal.
- ▶ Select mode **D**, **B** or **R**.
- ▶ Release the brake pedal and depress the accelerator pedal.

**i** With an automatic gearbox or drive selector, if the brake does not release automatically, check that the front doors are correctly closed.

**!** When stationary with the engine running, do not depress the accelerator pedal unnecessarily. Risk of parking brake release.

### Automatic application

With the vehicle stationary, the parking brake is **automatically applied when the engine is switched off**.

**!** It is not applied automatically if the engine stalls or enters STOP mode of Stop & Start.

**i** With automatic operation, it is also possible to manually apply or release the parking brake using the control lever.

## Special cases

### Immobilising the vehicle with the engine running

To immobilise the vehicle with the engine running, briefly pull the control lever.

### Parking the vehicle with the brake released

**!** In very cold conditions (ice), applying the parking brake is not recommended. To immobilise the vehicle, engage a gear or place the chocks against one of the wheels.

### Immobilising the vehicle with the parking brake released

- ▶ Switch off the engine.
- ▶ Switch on the ignition again, without starting the engine.
- ▶ Release the parking brake manually by pushing the control lever while keeping your foot on the brake pedal.
- ▶ Switch off the ignition.

**i** With an automatic gearbox or drive selector, mode **P** is automatically selected when the ignition is switched off. The wheels are blocked.

For more information on **Changing to free-wheeling**, refer to the corresponding section.

**i** With an automatic gearbox or drive selector, while mode **N** is selected, opening the driver's door triggers an audible signal. It stops when the driver's door closes again.

## Deactivating automatic operation

In some situations, for example when it is extremely cold or when towing (e.g. caravan, breakdown), it may be necessary to deactivate automatic operation of the system.

- ▶ Start the engine.
- ▶ Use the control lever to apply the parking brake, if it is released.
- ▶ Take your foot fully off the brake pedal.
- ▶ Hold the control lever pressed in the release direction for between 10 and a maximum of 15 seconds.
- ▶ Release the control lever.
- ▶ Depress and hold the brake pedal.
- ▶ Pull the control lever in the "Application" direction for 2 seconds.



This indicator lamp on the instrument panel comes on to confirm deactivation of the automatic functions.

- ▶ Release the control lever and the brake pedal.

From now on, the parking brake can only be applied and released manually using the control lever.

Repeat this procedure to reactivate automatic operation (confirmed by the indicator lamp on the instrument panel going off).

## Emergency braking

In the event of a fault with the brake pedal or in an exceptional situation (e.g. driver taken ill, driver under instruction), a continuous pull on the electric parking brake control lever will brake the vehicle. Braking continues while the control lever is pulled, and ceases when the control lever is released.

The ABS and DSC systems stabilise the vehicle during emergency braking.

If emergency braking malfunctions, the message "Parking brake control faulty" will be displayed on the instrument panel.



If the ABS and DSC systems malfunction, indicated by lighting one or both warning lamps on the instrument panel, the vehicle's stability is no longer ensured. In this event, the driver must keep the vehicle stable by successively pulling and releasing the control lever, repeating the operation until the vehicle has stopped.

## 6-speed manual gearbox

### Engaging 5<sup>th</sup> or 6<sup>th</sup> gear

► Move the gear selector fully to the right to engage 5<sup>th</sup> or 6<sup>th</sup> gear.

! Failure to follow this instruction could cause permanent damage to the gearbox (inadvertent engagement of 3<sup>rd</sup> or 4<sup>th</sup> gear).

### Engaging reverse gear

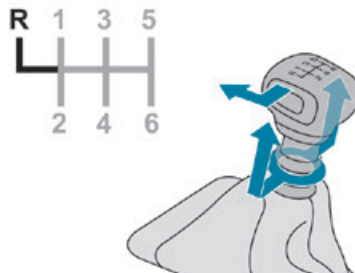

► Raise the ring under the knob and move the gear selector to the left, then forwards.

! Only engage reverse gear when the vehicle is stationary with the engine at idle.

i As a safety precaution and to facilitate starting the engine:

- Always select neutral.
- Press the clutch pedal.

## Automatic gearbox (EAT6)

6-speed automatic gearbox which offers a choice between the comfort of automatic operation or manual gear changing.

Two driving modes are available:

- **Automatic** operation for electronic management of the gears by the gearbox.
- **Manual** operation for sequential changing of the gears by the driver.

### Gear selector module

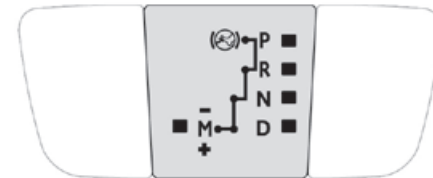

- P. Park
  - Vehicle immobilised, parking brake applied or released.
  - Engine starting.
- R. Reverse
  - Reversing manoeuvres, vehicle stationary, engine at idle.
- N. Neutral
  - Vehicle immobilised, parking brake applied.
  - Engine starting.
- D. Automatic operation

- M. + / -** Manual operation
- ▶ To shift up/down through the gears, push the control backwards/forwards.

## Information displayed on the instrument panel

When a position is selected in the grate with the gear selector, the corresponding indicator lamp lights up on the instrument panel.

- P.** Park
- R.** Reverse
- N.** Neutral
- D.** Drive (automatic operation)
- 1...6.** Gear engaged during manual operation
- .** Instruction not processed in manual operation

## Starting the vehicle



- ▶ With your foot on the brake pedal, select position **P** or **N**.

- ▶ Start the engine.

If the conditions are not met, you will hear an audible signal, accompanied by the display of a message.

- ▶ With the engine running, press the brake pedal.
- ▶ Release the parking brake, unless it is programmed to automatic mode.
- ▶ Select position **R**, **D** or **M**.
- ▶ Gradually release the brake pedal.

The vehicle moves off immediately.

**i** If position **N** is selected inadvertently while driving, allow the engine to return to idle, then select position **D** to accelerate.

**!** When the engine is running at idle with the brakes released, if position **R**, **D** or **M** is selected, the vehicle moves even without the accelerator being pressed. Never leave children unattended in the vehicle when the engine is running. When carrying out maintenance with the engine running, apply the parking brake and select position **P**.

## Automatic operation

- ▶ Select position **D** for **automatic** changing of the six gears.

The gearbox then operates in auto-adaptive mode, without any intervention on the part of the driver. It continuously selects the most suitable gear according to the driving style, the road profile and the load in the vehicle.

For maximum acceleration without touching the selector, press the accelerator fully down (kick-down). The gearbox changes down automatically or holds the gear selected until the maximum engine speed is reached.

When braking, the gearbox changes down automatically to provide effective engine braking. If you release the accelerator sharply, the gearbox will not shift to a higher gear for safety reasons.

**!** Never select position **N** while the vehicle is moving.

Never select positions **P** or **R** unless the vehicle is completely stationary.

## Manual operation



To limit fuel consumption during an extended standstill with the engine running (for example, in a traffic jam), set the gear selector to **N** and apply the parking brake.

- ▶ Selecting position **M** enables sequential shifting between the six gears.
- ▶ To shift up/down through the gears, push the control backwards/forwards.

The gearbox only changes gear if the vehicle speed and engine speed conditions allow; otherwise, the rules for automatic operation are temporarily applied.

**M****4** **D** disappears, and the gears engaged appear in succession on the instrument panel.

If the engine speed is too low or too high, the selected gear flashes for a few seconds, then the gear actually engaged is shown.

It is possible to change from position **D** to position **M** at any time.

When the vehicle is stationary or moving very slowly, the gearbox selects gear **M1** automatically.

 This symbol is displayed if a gear is not engaged correctly (gear selector between two positions).

## Switching the vehicle off

Before switching off the engine, it is possible to engage position **P** or **N** to place the gearbox in neutral.

In both cases, apply the parking brake to immobilise the vehicle, unless it is programmed to automatic mode.

- i** If the selector is not in position **P**, when the driver's door is opened or approximately 45 seconds after the ignition is switched off, an audible signal sounds and a message appears.
- ▶ Return the gear selector to **P**; the audible signal stops and the message disappears.

## Malfunction

 In the event of a malfunction, this warning lamp comes on and a message is displayed, when the ignition is switched on. In this case, the gearbox goes into back-up mode and is locked in 3<sup>rd</sup> gear. It is possible to feel a significant jolt (without risk for the gearbox) while changing from **P** to **R** and from **N** to **R**. Do not exceed 62 mph (100 km/h), local speed restrictions permitting. Have it checked by a PEUGEOT dealer or a qualified workshop.

- !** There is a risk of damaging the gearbox:
- If the accelerator and brake pedals are pressed simultaneously.
  - In the event of a battery failure, forcing the selector from position **P** to another position.

## Automatic gearbox (EAT8)

Automatic 8 speed gearbox with a push selector. It also offers a manual mode with gear changes via control paddles situated behind the steering wheel.

### Gearbox selector positions

- P. Park**  
For parking the vehicle: the front wheels are blocked.
- R. Reverse gear**
- N. Neutral**  
For moving the vehicle with the ignition off, or to allow it to free-wheel.  
For more information on **Changing to free-wheeling**, refer to the corresponding section.
- D. Driving in automatic mode**  
The gearbox manages gear changes according to the style of driving, the road profile and the vehicle load.
- M. Driving in manual mode**  
The driver changes gear using the steering-mounted controls.

### Push selector

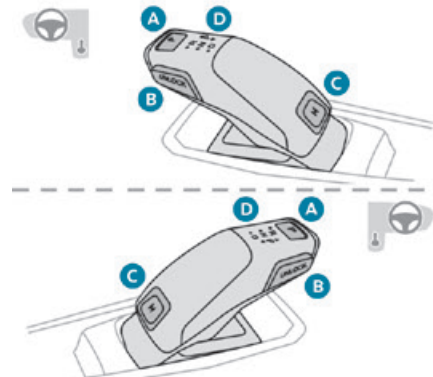

- A. Button P**  
To put the gearbox into Park mode.
- B. Unlock button**  
To unlock the gearbox and come out of **P** or to change to **R**, with the foot on the brake pedal.  
Press and hold this button before pushing the selector.
- C. Button M**  
To change from mode **D** to permanent manual mode.  
(Depending on version: with Full Park Assist, the manual mode is accessed via the **DRIVE MODE** control)
- D. Gearbox state indicator lamps (R, N, D)**

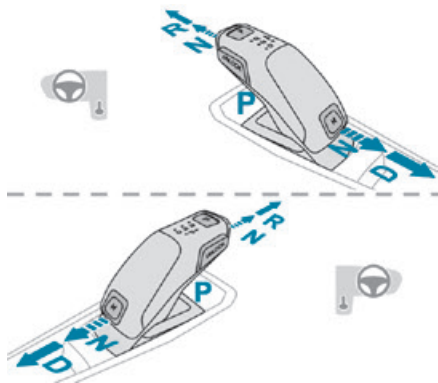

► Move the selector by pressing it forwards (**N** or **R**) or rearwards (**N** or **D**) once or twice, passing the point of resistance if necessary. The push selector returns to its initial position when released.

For example, to change from **P** to **R**, while pressing **Unlock**, push forward twice without crossing the point of resistance or push once crossing the point of resistance:

- In the first case, the gearbox goes from **P** to **N**, then from **N** to **R**.
- In the second case, the gearbox goes directly from **P** to **R**.

## Steering-mounted controls

In mode **M** or **D**, the steering-mounted control paddles can be used to change gear manually. They cannot be used to select neutral or to engage or disengage reverse gear.



- Pull the "+" or "-" paddle towards you and release to shift up or down a gear, respectively.

## Information displayed on the instrument panel

When the ignition is switched on, the gearbox status is displayed on the instrument panel:

**P** : Park.

**R** : Reverse.

**N** : Neutral.

**D1...D8** : Automatic mode.

**M1...M8** : Manual mode.

- : Instruction not processed in manual mode.

If the driver's door is opened with the ignition on, a message is displayed, prompting you to set the gearbox to mode **P**.

## Operation

With the engine running, if it is necessary to press the brake pedal and/or the **Unlock** button

in order to change mode, an alert message is displayed in the instrument panel. Only appropriate attempted changes of mode are accepted.

! With the engine running and the brakes released, if **R**, **D** or **M** is selected, the vehicle moves off, even without pressing the accelerator pedal.

! Never press the accelerator and brake pedals at the same time - risk of damage to the gearbox!  
In the event of a battery failure, you must place the chocks supplied with the vehicle tools against one of the wheels to immobilise the vehicle.

## Unlocking the gearbox

- From mode **P**:
  - Fully depress the brake pedal.
  - Press the **Unlock** button.
  - While continuing to press the brake pedal and the **Unlock** button, select another mode.
- From neutral **N**, at a speed below 3 mph (5 km/h):
  - Fully depress the brake pedal.
  - While continuing to depress the brake pedal, select another mode.

## Engaging reverse gear

- Slow down until you come to a stop.

▶ Depress the brake pedal, then press the **Unlock** button.

▶ While maintaining the presses, select mode **R**.

### Permanent manual mode

#### Entering the mode:

With EAT8 without Full Park Assist button:

- ▶ With mode **D** initially selected.
- ▶ Press button **M**; the green indicator lamp in the button comes on.

With EAT8 and Full Park Assist button:

- ▶ Press the **DRIVE MODE** control.
- ▶ Select "Manual" mode, which is displayed on the instrument panel.

#### Exiting the mode:

- ▶ Push forwards once to return to **D**.

or

- ▶ Press button **M**; the indicator lamp in the button goes off.

or

- ▶ Select another mode using the **DRIVE MODE** control.

### Switching off the ignition

To switch off the ignition, the vehicle must be stationary.

### Changing to free-wheeling

For more information on **Changing to free-wheeling**, refer to the corresponding section.

**i** If you open the driver's door while mode **N** is engaged, an audible signal will

sound. It will stop when you close the driver's door again.

### Special aspects of automatic mode

The gearbox selects the gear that offers optimum performance, taking account of the outside temperature, the road profile, the vehicle load and the driving style.

For maximum acceleration, press the accelerator fully down (kick-down). The gearbox changes down automatically or holds the selected gear until the maximum engine speed is reached. Steering mounted controls allow the driver to temporarily select a gear, if the vehicle speed and engine speed conditions permit.

### Special aspects of manual mode

The gearbox only changes from one gear to another if the vehicle speed and engine speed conditions permit.

### Starting the vehicle

From mode **P**:

- ▶ Fully depress the brake pedal.
- ▶ Start the engine.
- ▶ Maintaining pressure on the brake pedal, press the **Unlock** button.
- ▶ Push once or twice rearwards to select the automatic mode **D**, or forwards to engage reverse **R**.

From neutral **N**:

- ▶ Fully depress the brake pedal.

▶ Start the engine.

▶ Maintaining pressure on the brake pedal, push rearwards to select the automatic mode **D**, or forwards, while pressing the **Unlock** button to engage reverse **R**.

Then, from **D** or **R**:

- ▶ Release the brake pedal.
- ▶ Accelerate gradually to automatically release the electric parking brake.

The vehicle moves off immediately.

**!** With an automatic gearbox, never try to start the engine by pushing the vehicle.

### Stopping the vehicle

Whatever the state of the gearbox, when the ignition is switched off, mode **P** is engaged automatically and immediately.

However, in mode **N**, mode **P** will be engaged after a delay of 5 seconds (allowing for the process of putting the vehicle into free-wheeling mode).

Check that mode **P** has been engaged and that the electric parking brake was applied automatically; if not, apply it manually.

 The corresponding indicator lamps in the selector and the electric parking brake control lever must be on, as well as those in the instrument panel.

## Gearbox malfunction



This warning lamp comes on, accompanied by an audible signal and the display of a message.

Visit a PEUGEOT dealer or a qualified workshop. Do not drive faster than 62 mph (100 km/h), keeping to the speed limit.

The gearbox switches to back-up mode: mode **D** is locked in third gear, the steering-mounted control paddles are inoperative, mode **M** is no longer available. You may feel a significant jolt on engaging reverse gear. This will not damage the gearbox.

## Selector malfunction

### Minor malfunction



This warning lamp comes on, accompanied by the display of a message and an audible signal.

Drive cautiously and visit a PEUGEOT dealer or a qualified workshop.

In certain cases, the selector indicator lamps may no longer come on, but the gearbox state is still displayed on the instrument panel.

### Major malfunction



This warning lamp comes on, accompanied by the display of a message.

! Stop as soon as it is safe to do so, away from traffic, and call a PEUGEOT dealer or a qualified workshop.

## Drive selector (Electric)

The drive selector is a pulse selector with a regenerative braking function.

The drive selector provides traction control based on the driving style, the road profile and the vehicle load.

With regenerative braking activated, it also manages engine braking when the accelerator pedal is released.

- P.** Park  
For parking the vehicle: the front wheels are blocked.
- R.** Reverse gear
- N.** Neutral  
For moving the vehicle with the ignition off and allowing it to free-wheel.  
For more information on **Changing to free-wheeling**, refer to the corresponding section.
- D/B.** Automatic forward drive (**D**) or automatic forward drive with regenerative braking (**B**)

## Information displayed on the instrument panel

When the ignition is switched on, the drive selector status is displayed on the instrument panel:

- P** : Park.
- R** : Reverse.
- N** : Neutral.
- D** : Automatic forward drive.

**B** : Automatic forward drive with regenerative braking activated.

## Operation

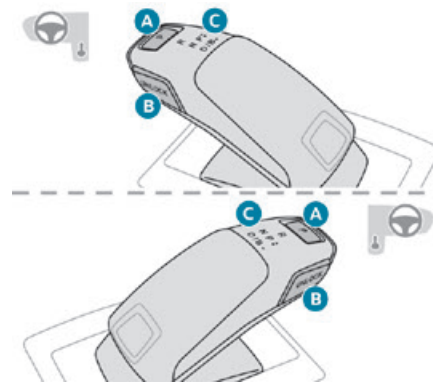

- A.** Button **P**  
To put the gearbox into Park mode.
- B.** **Unlock** button  
To unlock the selector and come out of **P** or change to **R**, with the foot on the brake pedal. Press and hold this button before pushing the selector.
- C.** Selector state indicators (**R**, **N**, **D/B**)
  - ▶ Move the selector by pushing it forwards (**N** or **R**) or backwards (**N** or **D/B**) once or twice, passing the point of resistance if necessary. The push selector returns to its initial position when released.

For example, to change from **P** to **R**, either push forwards twice without passing the point of resistance or push just once, passing the point of resistance:

- In the first case, the selector goes from **P** to **N**, then from **N** to **R**.
- In the second case, the selector goes directly from **P** to **R**.

## Regenerative braking

The regenerative braking function emulates engine braking, slowing the vehicle with no need to depress the brake pedal. When the driver releases the accelerator pedal, the vehicle slows down more quickly and recharges the battery.

► From mode **D/B**, moving the push selector backwards activates/deactivates the function. The **D** on the instrument panel is replaced with a **B**.

The state of the function is not saved when the ignition is switched off.

**!** The driver must always be ready to use the brake pedal: in certain situations (e.g. full battery, extreme temperatures), the regenerative braking level may be temporarily limited and deceleration may be reduced.

## Driving modes

The number and type of driving modes available depend on the vehicle's engine and equipment.

Driving modes are selected using the following control:

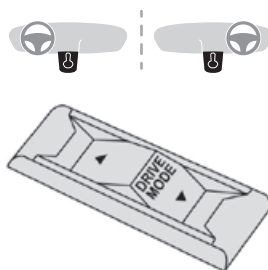

Pressing the control displays the modes on the instrument panel.

With an electric motor, you cannot select a mode if the **READY** lamp is off.

When the message disappears, the selected mode is activated and remains indicated on the instrument panel (except **NORMAL** mode). With Advanced Grip Control, additional driving modes are available, offering enhanced traction control.

For more information on **Advanced Grip Control**, refer to the corresponding section. Whenever the ignition is switched on, **NORMAL** mode is selected by default.

### **NORMAL**

Restores the vehicle's original settings.  
Reduces traction battery electrical energy consumption by limiting engine torque.

### **ECO**

Reduces energy consumption by restricting the performance of the heating and air conditioning systems, although it does not deactivate them. Free-wheeling in **ECO** mode: depending on version, with the EAT8 gearbox, moving into "free-wheeling" is encouraged to slow the vehicle down without using engine braking. You can save fuel by anticipating the need to slow down and lifting your foot fully off the accelerator pedal. Further reduces traction battery electrical energy consumption by limiting engine torque.

### **SPORT**

Enables more dynamic driving, acting on the power steering, accelerator and gear changes with an automatic gearbox and the possibility of displaying the vehicle's dynamic settings on the instrument panel.

### **MANUAL**

Permanent "Manual" mode with an automatic gearbox and Full Park Assist. Enables manual gear changing using the steering-mounted paddles.

## Hill start assist

This system keeps your vehicle briefly stationary (for approximately 2 seconds) when making a hill start, while you transfer your foot from the brake pedal to the accelerator pedal.

This system is only active when:



- the vehicle is completely stationary, with your foot on the brake pedal,
- certain slope conditions are met,
- the driver's door is closed.

**!** Do not leave the vehicle while it is being held temporarily by hill start assist.

If someone needs to get out of the vehicle with the engine running, apply the parking brake manually. After that, ensure that the parking brake indicator lamp and the indicator lamp **P** in the electric parking brake control lever are on fixed.

**!** The hill start assist function cannot be deactivated. However, use of the parking brake to immobilise the vehicle interrupts its operation.

## Operation

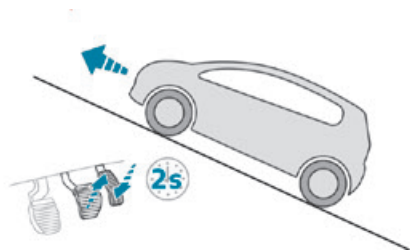

**On an ascending slope, with the vehicle stationary, the vehicle is held for a short time when you release the brake pedal:**

- provided you are in first gear or neutral with a manual gearbox.
- provided you are in mode **D** or **M** with an automatic gearbox.
- provided you are in mode **D** or **B** with a drive selector.

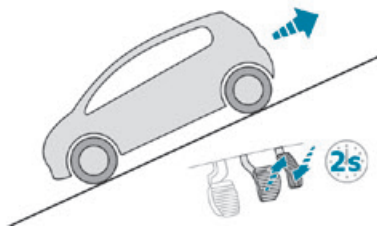

**On a descending slope, with the vehicle stationary and reverse gear engaged, the vehicle is held for a short time when you release the brake pedal.**

## Malfunction



These warning lamps come on in the event of a malfunction.

Contact a PEUGEOT dealer or a qualified workshop to have the system checked.

## Gear efficiency indicator

This system helps reduce fuel consumption by recommending the most appropriate gear.

## Operation

Depending on the driving situation and the vehicle's equipment, the system may advise skipping one or more gears.

Gear engagement recommendations are only optional. In fact, the configuration of the road, the traffic density and safety remain determining factors when choosing the best gear. Therefore, the driver remains responsible for deciding whether or not to follow the system's advice. This function cannot be deactivated.



With an automatic gearbox, the system is only active in manual operation.



The information appears in the instrument panel in the form of an arrow and the recommended gear.



The system adapts its gear shift recommendation according to the driving conditions (slope, load, etc.) and the driver's requirements (power, acceleration, braking, etc.).

The system never suggests:

- engaging first gear,
- engaging reverse.

## Stop & Start

The Stop & Start function puts the engine temporarily into standby - STOP mode - during phases when the vehicle is stopped (red lights,

queues, etc.). The engine restarts automatically - START mode - as soon as the driver wishes to move off again.

Primarily designed for urban use, the function is intended to reduce fuel consumption and exhaust emissions as well as the noise level when stationary.

The function does not affect the functionalities of the vehicle, in particular the braking.

### Deactivation/Reactivation

The function is **activated** by default when the ignition is switched on.



It is set via the **Driving / Vehicle** touch screen menu.

A message in the instrument panel confirms the change of status.

When the function is deactivated, if the engine was in standby, it restarts immediately.

### Associated indicator lamps



Function activated.



Function deactivated or malfunction.

### ! Opening the bonnet

Before doing anything under the bonnet, deactivate the Stop & Start system to avoid

any risk of injury caused by the engine restarting automatically.



### ! Driving on flooded roads

Before entering into a flooded area, it is strongly recommended that you deactivate the Stop & Start system.

For more information on **Driving recommendations**, particularly on flooded roads, refer to the corresponding section.

## Operation

### Main conditions for operation

- The driver's door must be closed.
- The driver's seat belt must be fastened.
- The state of charge of the battery must be sufficient.
- The temperature of the engine must be within its nominal operating range.
- The outside temperature must be between 0°C and 35°C.

### Putting the engine into standby (STOP mode)

The engine automatically goes into standby as soon as the driver indicates the intention of stopping.

- With a **manual gearbox**: with the gear lever in neutral and the clutch pedal released.

- With an **automatic gearbox**: with the brake pedal depressed until the vehicle stops or the gear selector in position **N**, with the vehicle stopped.

### Time counter

A time counter adds up the time spent in standby during a journey. It resets to zero every time the ignition is switched on.

### Special cases:

The engine will not go into standby if all of the conditions for operation are not met and in the following cases.

- Steep slope (ascending or descending).
- Vehicle has not exceeded 6 mph (10 km/h) since the last engine start (with the key or the "START/STOP" button).
- Needed to maintain a comfortable temperature in the passenger compartment.
- Demisting active.



In these cases, this indicator lamp flashes for a few seconds, then goes off.

**i** After the engine has restarted, STOP mode is not available until the vehicle has reached a speed of 5 mph (8 km/h).

**i** During parking manoeuvres, STOP mode is not available for a few seconds after coming out of reverse gear or turning the steering wheel.

## Engine restarting (START mode)

The engine automatically restarts as soon as the driver indicates the intention of moving off again.

- ▶ **With a manual gearbox:** with the clutch pedal fully depressed.
- ▶ **With an automatic gearbox:**
  - With the selector in position **D** or **M**: with the brake pedal released.
  - With the selector in position **N** and the brake pedal released: with the selector at **D** or **M**.
  - With the selector in position **P** and the brake pedal depressed: with the selector at **R**, **N**, **D** or **M**.
  - Reverse gear engaged.

### Special cases

The engine restarts automatically if all the operating conditions are met again and in the following cases.

- With a manual gearbox: vehicle speed exceeds 2.5 mph (4 km/h),
- With an automatic gearbox, in mode **N**, vehicle speed exceeds 0.6 mph (1 km/h).



In these cases, this indicator lamp flashes for a few seconds, then goes off.

## Malfunctions



In the event of a malfunction, this warning lamp flashes for a few moments, then remains on, accompanied by an onscreen message.

Have the vehicle checked by a PEUGEOT dealer or a qualified workshop.

## The vehicle stalls in STOP mode

All of the instrument panel warning lamps come on if there is a fault.

- ▶ Switch off the ignition then start the engine again with the key or the "START/STOP" button.



The Stop & Start system requires a 12 V battery of specific technology and specification.

All work concerning the battery must be carried out only by a PEUGEOT dealer or a qualified workshop.

## Under-inflation detection

This system automatically checks the pressures of the tyres while driving.

It compares the information given by the wheel speed sensors with **reference values, which must be reinitialised every time the tyre pressures are adjusted or a wheel changed.**

The system triggers an alert as soon as it detects a drop in the inflation pressure of one or more tyres.



Under-inflation detection does not replace the need for vigilance on the part of the driver.

This system does not avoid the need to regularly check the tyre pressures (including the spare wheel), especially before a long journey.

Driving with under-inflated tyres, particularly in adverse conditions (heavy load, high speed, long journey):

- worsens road-holding.
- lengthens braking distances.
- causes premature wear of the tyres.
- increases energy consumption.



The inflation pressures defined for the vehicle can be found on the tyre pressure label.

For more information on the **Identification markings**, refer to the corresponding section.



### Checking tyre pressures

This check should be done when the tyres are "cold" (vehicle stopped for 1 hour or after a journey of less than 6 miles (10 km) at moderate speeds).

Otherwise, add 0.3 bar to the pressures shown on the label.



### Snow chains

The system does not have to be reinitialised after fitting or removing snow chains.

## Under-inflation alert



This is signalled by the fixed illumination of this warning lamp, accompanied by an

audible signal and, depending on equipment, the display of a message.

- ▶ Reduce speed immediately, avoid excessive steering movements and avoid sudden braking.
- ▶ Stop the vehicle as soon as it is safe to do so.

**!** The loss of pressure detected does not always cause visible bulging of the tyre. Do not rely on just a visual check.

- ▶ Using a compressor, such as the one in the temporary puncture repair kit, check the pressures of the four tyres when cold.
- ▶ If it is not possible to make this check immediately, drive carefully at reduced speed.
- ▶ In the event of a puncture, use the temporary puncture repair kit or the spare wheel (depending on equipment).

**i** The alert is kept active until the system is reinitialised.

## Reinitialisation

Reinitialise the system after adjusting one or more tyre pressures and after changing one or more wheels.

**!** Before reinitialising the system, make sure that the pressures of the four tyres are correct for the conditions of use of the

vehicle and conform to the values written on the tyre pressure label.

Check the pressures of the four tyres before performing the reinitialisation.

The system does not advise if a pressure is incorrect at the time of reinitialisation.



With the vehicle stationary, the system is reinitialised via the **Driving /**

**Vehicle** touch screen menu..

## Malfunction



These warning lamps come on in the event of a malfunction.

A message appears, accompanied by an audible signal.

In this case, the tyre under-inflation monitoring function is no longer performed.

Have the system checked by a PEUGEOT dealer or a qualified workshop.

## Driving and manoeuvring aids - General recommendations

**i** Driving and manoeuvring aids cannot, in any circumstances, replace the need for vigilance on the part of the driver. The driver must comply with the Highway Code, must remain in control of the vehicle in all circumstances and must be able to retake control of it at all times. The driver must adapt

the speed to climactic conditions, traffic and the state of the road.

It is the driver's responsibility to constantly check the traffic, to assess the relative distances and speeds of other vehicles and to anticipate their movements before indicating and changing lane.

The systems cannot exceed the limits of the laws of physics.

### **i** Driving aids

You should hold the steering wheel with both hands, always use the interior and exterior rear view mirrors, always keep the feet close to the pedals and take a break every two hours.

### **i** Manoeuvring aids

The driver must always check the surroundings of the vehicle before and during the whole manoeuvre, in particular using the mirrors.

### **!** Radar

The operation of the radar as well as the associated functions may be impaired through the accumulation of dirt (mud, frost, etc.), in certain difficult weather conditions (very heavy rain, snow) or if the bumper is damaged. If the front bumper is to be repainted, contact a PEUGEOT dealer or a qualified workshop;

certain types of paint could interfere with the operation of the radar.



### ! Driving aids camera

This camera and its associated functions may be impaired or not work if the windscreen area in front of the camera is dirty, misty, frosty, covered with snow, damaged or masked by a sticker.

On versions with camera alone, this message indicates to you that the camera is obstructed: **"Driving aids camera: visibility limited, see user guide"**.

In humid and cold weather, demist the windscreen regularly.

Poor visibility (inadequate street lighting, heavy rain, thick fog, snowfall), dazzle (headlamps of an oncoming vehicle, low sun, reflections on a damp road, leaving a tunnel, alternating shade and light) can also impair detection performance.

In the event of a windscreen replacement, contact a PEUGEOT dealer or a qualified workshop to recalibrate the camera; otherwise, the operation of the associated driving aids may be disrupted.

### i Other cameras

The images from the camera(s) displayed on the touch screen or on the instrument panel may be distorted by the relief.

In the presence of areas in shade, or in conditions of bright sunlight or inadequate lighting, the image may be darkened and with lower contrast.

Obstacles may appear further away than they actually are.

### ! Sensors

The operation of the sensors as well as the associated functions may be disturbed by sound interference such as that emitted by noisy vehicles and machinery (e.g. lorries, pneumatic drills), by the accumulation of snow or dead leaves on the road or in the event of damaged bumpers and mirrors. When reverse gear is engaged, an audible signal (long beep) indicates that the sensors may be dirty.

A front or rear impact to the vehicle can upset the sensors' settings, which is not always detected by the system: distance measurements may be distorted.

The sensors do not systematically detect obstacles that are too low (pavements, studs) or too thin (trees, posts, wire fences). Certain obstacles located in the sensors' blind spots may not be detected or may no longer be detected during the manoeuvre.

Certain materials (fabrics) absorb sound waves: pedestrians may not be detected.

### i Maintenance

Clean the bumpers and door mirrors and the field of vision of the cameras regularly. When washing your vehicle at high pressure, direct the spray from at least 30 cm away from the radar, sensors and cameras.

### ! Mats

The use of mats not approved by PEUGEOT may interfere with the operation of the speed limiter or cruise control.

To avoid any risk of jamming the pedals:

- ▶ ensure that the mat is secured correctly,
- ▶ never fit one mat on top of another.

### i Units of speed

Ensure that the units of speed displayed on the instrument panel (mph or km/h) are those for the country you are driving in. If this is not the case, when the vehicle is stationary, set the display to the required units of speed so that it complies with what is authorised locally.

In case of doubt, contact a PEUGEOT dealer or a qualified workshop.

## Speed Limit Recognition and Recommendation

Refer to the **General recommendations on the use of driving and manoeuvring aids.**

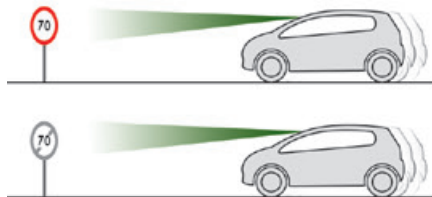

This system displays the maximum authorised speed in the instrument panel, according to the speed limits in the country in which you are driving, using:

- Speed limit signs detected by the camera.
- Speed limit details from the navigation system mapping.



**!** You should update your navigation mapping regularly in order to receive accurate speed limit information from the system.



- Signs indicating an intersection area detected by the camera:

Sign detected	Suggested speed (calculated)
<p><b>Entry into an intersection area</b> Example:</p> 	<p><b>Without PEUGEOT Connect Nav</b> 10 mph or 20 km/h (depending on the units of the instrument panel)</p> <p><b>With PEUGEOT Connect Nav</b> Display of the speed in force in the country in which you are driving.</p>

- Certain qualifier plates are detected by the camera:

Qualifier plate detected	Display of the speed associated with the qualifier plate
<p><b>Speed limit in rain</b> Examples:</p> 	<p>If the wiper control stalk is in the "intermittent wipe" or "automatic wipe" position (in order to activate the rain sensor): 68 mph (110 km/h) (for example)</p>

Qualifier plate detected	Display of the speed associated with the qualifier plate
<p><b>Speed limit if towing</b></p> 	<p>If an approved towing device is fixed to the vehicle: 56 mph (90 km/h) (for example)</p>
<p><b>Speed limit applicable over a certain distance</b> Example:</p> 	<p>43 mph (70 km/h) (for example)</p>
<p><b>Speed limit for vehicles whose gross vehicle weight or gross train weight is less than 3.5 tonnes</b></p> 	<p>56 mph (90 km/h) (for example)</p>

Qualifier plate detected	Display of the speed associated with the qualifier plate
<b>Speed limit in snow</b> Example: 	If the exterior temperature is below 3 °C: 19 mph (30 km/h) (for example) with a "snowflake" symbol
<b>Speed limit at certain times</b> Example: 	19 mph (30 km/h) (for example) with a "clock" symbol

**!** The units for the speed limit (mph or km/h) depend on the country you are driving in. This should be taken into account so that you observe the speed limit. For the system to operate correctly when you change country, the units for speed in the instrument panel must be those for the country you are driving in.

**!** The automatic reading of road signs is a driving aid system and does not always display speed limits correctly. The speed limit signs present on the road always take priority over the display by the system. The system is designed to detect signs that conform to the Vienna Convention on road signs.

**i** Specific speed limits, such as those for heavy goods vehicles, are not displayed. The display of the speed limit in the instrument panel is updated as you pass a speed limit sign intended for cars (light vehicles).

## Activation / Deactivation

By default, the system is automatically activated at every engine start.



It is set via the **Driving / Vehicle** touch screen menu.

## Information displayed on the instrument panel

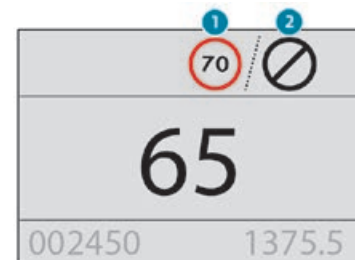

1. Detected speed limit indication or
2. End of speed limit indication



The system is active but is not detecting speed limit information.



On detecting speed limit information, the system displays the value.



In the case of suggested maximum speeds, the first time the vehicle exceeds the suggested speed by **more than 3 mph (5 km/h)** (e.g. 59 mph (95 km/h)), the speed is displayed flashing for 10 seconds.

## Operating limits

The system does not take account of reduced speed limits, especially those imposed in the following cases:

- Atmospheric pollution.
- Towing.
- Driving with a space-saver type spare wheel or snow chains fitted.
- Tyre repaired using the temporary puncture repair kit.
- Young drivers.

The system may not display the speed limit if it does not detect a speed limit sign within a preset period and in the following situations:

- Road signs that are obstructed, non-standard, damaged or bent.
- Obsolete or incorrect maps.

## Recommendation



In addition to **Speed Limit Recognition and Recommendation**, the driver can select the speed displayed as a speed setting for the speed limiter or cruise control using the speed limiter or cruise control memorisation button.

If rain is detected, the system will propose to the driver a speed setting lower than the speed read/obtained from the mapping in order to adapt to the weather conditions (example: on a motorway, the proposed speed will be 68 mph (110 km/h) instead of 81 mph (130 km/h)).

**i** For more information on the **Speed limiter, Cruise control or Adaptive cruise control**, refer to the corresponding sections.

## Steering mounted controls

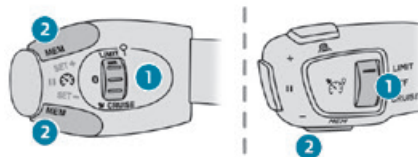

1. Speed limiter/cruise control mode selection

2. Memorise the speed setting

## Information displayed on the instrument panel



3. Speed limit indication
4. Speed memorisation prompt
5. Current speed setting

## Memorising the speed



► Switch on the speed limiter/cruise control. The speed limiter/cruise control information is displayed.

Upon detecting a sign suggesting a new speed setting, the system displays the value and "MEM" flashes for a few seconds, prompting you to save it as the new speed setting.

**i** If there is a difference of less than 6 mph (9 km/h) between the speed setting and the speed displayed by the Speed Limit Recognition and Recommendation, the "MEM" symbol is not displayed.



Depending on the road conditions, several speeds may be displayed.

► Press button **2**once to save the suggested speed value.

A message is displayed to confirm the request.

► Press button **2**again to confirm and save the new speed setting.

The display then reverts to its previous state.

## Extended Traffic Sign Recognition

Refer to the **General recommendations on the use of driving and manoeuvring aids**.



This additional system recognises these **road signs** and displays them in the instrument panel if the appropriate display mode is selected.

One-way street: if you start driving the wrong way down a one-way street, an alert message, including the sign's symbol, is displayed in the instrument panel (request to check the traffic direction).

Other signs: when approaching one of these signs, the sign's symbol is displayed in the instrument panel.

**!** The actual road signs always take priority over the display from the system.

The signs must comply with the Vienna Convention on road signs.

### Activation / Deactivation



It is set via the **Driving / Vehicle** touch screen menu.

### Speed limiter

Refer to the **General recommendations on the use of driving and manoeuvring aids**.



This system prevents the vehicle from exceeding the speed programmed by the driver (speed setting).

The speed limiter is **switched on** manually.

The minimum speed setting is 19 mph (30 km/h).

The speed setting remains in the system memory when the ignition is switched off.

## Steering-mounted control

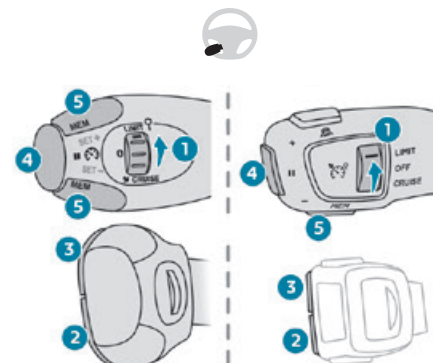

1. ON (**LIMIT** position) / OFF
2. Reduce the speed setting
3. Increase the speed setting
4. Pause / resume speed limiter with the speed setting previously stored
5. Use the speed suggested by the Speed Limit Recognition and Recommendation (**MEM** display)

For more information on the **Speed Limit Recognition and Recommendation**, refer to the corresponding section.

## Information displayed on the instrument panel

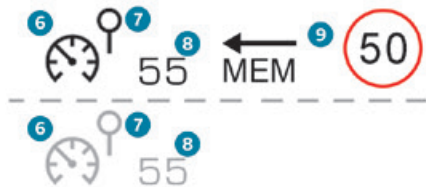

6. Speed limiter on/pause
7. Speed limiter mode selected
8. Programmed speed value
9. Speed suggested by the Speed Limit recognition and recommendation system (depending on version)

## Switching on/pausing

- ▶ Turn thumbwheel 1 to the "LIMIT" position to select the speed limiter; the function is paused.
- ▶ If you are satisfied with the limit speed setting (most recent speed setting programmed in the system), press button 4 to switch the speed limiter on.
- ▶ Pressing button 4 again temporarily pauses the function.

**i** An audible warning will sound if the vehicle's speed exceeds the speed setting for an extended period.

## Adjusting the limit speed setting

You do not have to switch the speed limiter on in order to set the speed.

To modify the limit speed setting based on the vehicle's current speed:

- ▶ Briefly press button 2 or 3 to change the value in steps of + or - 1 mph (1.6 km/h).
- ▶ Press and hold button 2 or 3 to change the value in steps of + or - 5 mph (8 km/h).

To modify the cruise speed setting based on the speed suggested by the Speed Limit Recognition and Recommendation, as shown on the instrument panel:

- ▶ Press button 5 once; a message is displayed to confirm the memorisation request.
- ▶ Press button 5 again to save the suggested speed.

The speed is immediately shown on the instrument panel as the new speed setting.

## Temporarily exceeding the speed setting

- ▶ Press the accelerator pedal down fully.

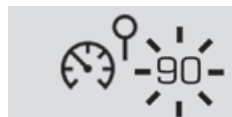

The speed limiter is deactivated temporarily and the displayed speed setting flashes.

- ▶ Release the accelerator pedal to return to below the programmed speed. When the limit speed is exceeded but this is not due to action by the driver (in case of a steep slope, for example), an audible signal triggers immediately.

**!** On a steep descent or in the event of sharp acceleration, the speed limiter will not be able to prevent the vehicle from exceeding the speed setting. Brake if necessary to control the speed of your vehicle.



Once the speed of the vehicle returns to the programmed setting, the speed limiter functions again: the display of the speed setting becomes fixed again.

## Switching off

- ▶ Turn the thumbwheel 1 to the "OFF" position: the display of information on the speed limiter disappears.

## Malfunction



Dashes are displayed (flashing, initially, then fixed) in the event of a speed limiter malfunction. Have the system checked by a PEUGEOT dealer or a qualified workshop.

## Cruise control - particular recommendations

**!** For the safety of everyone, only use the cruise control where the driving conditions allow running at a constant speed and keeping an adequate safety distance. **Remain vigilant** when the cruise control is activated. If you hold one of the speed setting modification buttons down, a very rapid change in the speed of your vehicle may occur.

When **descending a steep hill**, the cruise control system cannot prevent the vehicle from exceeding the set speed. Brake if necessary to control the speed of your vehicle.

On **steep climbs** or when towing, the set speed may not be reached or maintained.

### **i** Exceeding the programmed speed setting

The speed setting can be exceeded **temporarily** by pressing the accelerator pedal (the programmed speed flashes). To return to the speed setting, release the accelerator pedal (when this speed is reached again, the display of the speed stops flashing).

### **!** Operating limits

Never use the system in the following situations:

- In an urban area with the risk of pedestrians crossing the road.
- In heavy traffic (except versions with the Stop & Go function).
- On winding or steep roads.
- On slippery or flooded roads.
- In poor weather conditions.
- Driving on a speed circuit.
- Driving on a rolling road.
- When using snow chains, non-slip covers or studded tyres.

## Cruise control

Refer to the **General recommendations on the use of driving and manoeuvring aids** and to **Cruise control - particular recommendations**.



This system automatically keeps the vehicle's speed at the cruise value

programmed by the driver (speed setting), without using the accelerator pedal. Cruise control is **switched on** manually. It requires a minimum vehicle speed of 25 mph (40 km/h).

With a manual gearbox, third gear or higher must be engaged.

With an automatic gearbox, mode **D** or second gear or higher in mode **M** must be engaged.

With a drive selector, mode **D** or **B** must be engaged.

**i** Cruise control remains active after changing gear, regardless of the gearbox type, on engines fitted with Stop & Start.

**i** Switching off the ignition cancels any speed setting.

## Steering mounted control

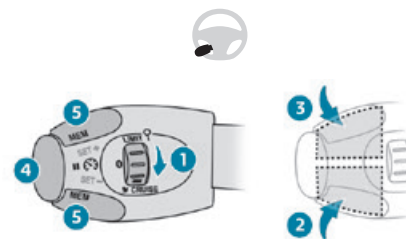

1. ON (CRUISE position) / OFF

2. Activate cruise control at the current speed / decrease speed setting
3. Activate cruise control at the current speed / increase speed setting
4. Pause / resume cruise control with the speed setting previously saved
5. Use the speed suggested by the Speed Limit Recognition and Recommendation (**MEM** display)

For more information on the **Speed Limit Recognition and Recommendation**, refer to the corresponding section.

## Information displayed on the instrument panel

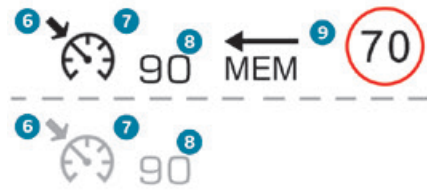

6. Cruise control pause/resume
7. Cruise control mode selection
8. Speed setting value
9. Speed suggested by the Speed Limit recognition and recommendation system (depending on version)

## Switching on/pausing

- ▶ Turn thumbwheel **1** to the "**CRUISE**" position to select cruise control mode; the function is paused.
- ▶ Press button **2** or **3** to activate cruise control and save a speed setting when the vehicle has reached the desired speed; the vehicle's current speed is saved as the speed setting.
- ▶ Release the accelerator pedal.
- ▶ Pressing button **4** temporarily pauses the function.
- ▶ Pressing button **4** again restores operation of the cruise control (ON).

- i Operation of the cruise control can also be paused temporarily:
  - by pressing the brake pedal.
  - automatically, if the electronic stability control (ESC) system is triggered.

## Modifying the cruise speed setting

Cruise control must be active.

To modify the cruise speed setting, based on the current speed of the vehicle:

- ▶ Briefly press button **2** or **3** to change the value in steps of + or - 1 mph (km/h).
- ▶ Press and hold button **2** or **3** to change the value in steps of + or - 5 mph (km/h).

**!** Pressing and holding button **2** or **3** results in a rapid change in the speed of the vehicle.

**!** As a precaution, we recommend setting a cruise speed fairly close to the current speed of your vehicle, to avoid any sudden acceleration or deceleration of the vehicle.

To modify the cruise speed setting using the speed suggested by the Speed Limit Recognition and Recommendation shown on the instrument panel:

- ▶ Press button **5** once; a message is displayed to confirm the memorisation request.
- ▶ Press button **5** again to save the suggested speed.

The speed is immediately shown on the instrument panel as the new speed setting.

## Switching off

- ▶ Turn the thumbwheel **1** to the "**OFF**" position: the cruise control information disappears from the screen.

## Malfunction



Dashes are displayed (flashing, initially, then fixed) in the event of a cruise control system malfunction.

Have the system checked by a PEUGEOT dealer or a qualified workshop.

## Drive Assist Plus

Only available on versions with the EAT8 automatic gearbox and gear selector.

This system automatically adjusts the speed and corrects the trajectory, using the Adaptive Cruise Control with Stop & Go function in conjunction with the Lane Positioning Assist.

These two functions must be activated and in operation.

This system is especially suitable for driving on motorways and main roads.

For more information on **Adaptive Cruise Control** and **Lane Positioning Assist**, refer to the corresponding sections.

**!** The system assists the driver by acting on the steering, acceleration and braking, within the limits of the laws of physics and the capabilities of the vehicle. Certain road infrastructure elements or vehicles present on the road may not be properly seen or may be poorly interpreted by the camera and radar, resulting in an unexpected change in direction, a lack of steering correction and/or inappropriate management of acceleration or braking.

## Adaptive Cruise Control

Refer to the **General recommendations on the use of driving and manoeuvring aids** and to **Cruise control - particular recommendations**.

This system **automatically** maintains the speed of your vehicle at a value which you set (speed setting), while keeping a safe distance from the vehicle in front (target vehicle), and which has been set beforehand by the driver. The system automatically manages the acceleration and deceleration of the vehicle.

With the **Stop & Go function**, the system manages the braking until the vehicle comes to a complete stop and the restarting of the vehicle.

**!** The brake lamps come on if the vehicle is slowed down by the system. It can be dangerous to drive if the brake lamps are not in perfect working order.



To do so, it has a camera located at the top of the windscreen and, depending on version, a radar located in the front bumper.

**!** Primarily designed for driving on main roads and motorways, this system only works with moving vehicles driving in the same direction as your vehicle.

**i** If the driver operates a direction indicator to overtake a slower vehicle, the cruise control allows the vehicle to temporarily approach the vehicle in front to assist the overtaking manoeuvre, without ever exceeding the speed setting.

**!** Some vehicles present on the road may not be properly seen or may be poorly interpreted by the camera and/or radar (e.g. a lorry), which may lead to a poor assessment of the distances and lead to the vehicle inappropriately accelerating or braking.

## Steering mounted control

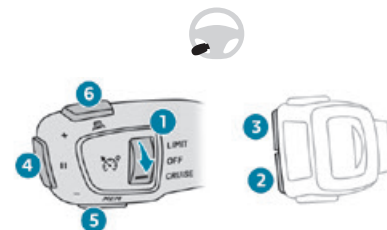

1. ON (**CRUISE** position) / OFF
2. Activation of cruise control at the current speed / decrease speed setting
3. Activation of cruise control at the current speed / increase speed setting

4. Pause / resume cruise control with the speed setting previously saved  
Confirmation of the restarting of the vehicle after automatic stop (versions with Stop & Go function)
5. Use the speed suggested by the Speed Limit Recognition and Recommendation (**MEM** display)
6. Display and adjustment of the distance setting to the vehicle in front

## Use

### Activating the system (pause)

► With the engine running, turn the thumbwheel **1** downwards to the **CRUISE** position. Cruise control is ready to operate (grey display).

### Switching on cruise control and setting the speed

With a manual gearbox, your speed must be between 19 and 112 mph (30 and 180 km/h). With an EAT8 automatic gearbox or a drive selector, your speed must be between 0 and 112 mph (0 and 180 km/h).

- Press button **2** or **3**: the current speed becomes the speed setting (minimum 19 mph (30 km/h)) and cruise control is immediately activated (green display).
- Press **3** to increase or **2** to decrease the speed setting (steps of 5 mph (km/h) if held pressed).

**!** Pressing and holding button **2** or **3** results in a rapid change in the speed of the vehicle.

### Pausing / resumption of cruise control

- Press **4** or depress the **brake pedal**. To pause cruise control, it is also possible to:
  - shift from mode **D** to **N**;
  - depress the clutch pedal for more than 10 seconds;
  - press the electric parking brake control.
- Press **4** to restart cruise control. Cruise control may have been paused automatically:
  - when the speed of the vehicle goes below 19 mph (30 km/h) with a manual gearbox.
  - when the speed of the engine goes below 1100 rpm with a manual gearbox.
  - by triggering of the ESC system.

With an EAT8 gearbox or a drive selector, following braking that has brought the vehicle to a complete stop, if the traffic conditions do not allow the vehicle to begin moving again within 3 seconds of stopping, press button **4** or the accelerator pedal to move off.

If the driver takes no action after the vehicle has been stopped, the electric parking brake is applied automatically after about 5 minutes.

**i** Cruise control remains active after changing gear, regardless of the gearbox type.

**!** When the driver attempts to reactivate cruise control, after the function has been paused, the message "Activation not possible, unsuitable conditions" is briefly displayed if reactivation is not possible (safety conditions not met).

### Changing the programmed speed setting with the Speed Limit Recognition and Recommendation function

- Press **5** to accept the speed suggested by the function on the instrument panel, then press again to confirm.

**!** To prevent sudden acceleration or deceleration of the vehicle, select a speed setting relatively close to the vehicle's current speed.

### Changing the inter-vehicle distance

- Press **6** to display the distance setting thresholds ("Distant", "Normal" or "Close"), then press again to select a threshold. After a few seconds, the option is accepted and will be memorised when the ignition is switched off.

### Temporarily exceeding the speed setting

- Fully depress the accelerator pedal. Distance monitoring and cruise control are deactivated while acceleration is maintained. "Cruise control suspended" is displayed.

## Deactivating the system

► Turn the thumbwheel 1 upwards to the OFF position.

## Information displayed on the instrument panel

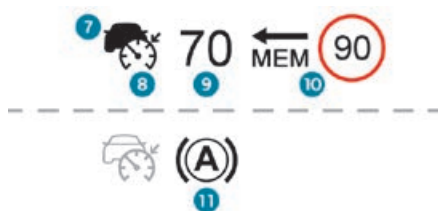

7. Vehicle detected by the system (full symbol)
8. Cruise control active (colour not grey)
9. Speed setting value
10. Speed suggested by the Speed Limit Recognition and Recommendation
11. Vehicle held stationary (versions with automatic gearbox or drive selector)



12. Inter-vehicle distance setting
13. Position of the vehicle detected by the system

## Messages and alerts

**i** The display of these messages or alerts is not sequential.

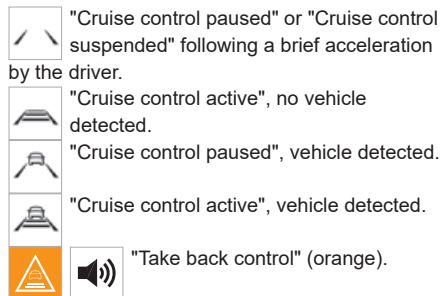

► Brake or accelerate, depending on the context.

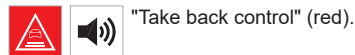

"Take back control" (red).

► **Take back control of the vehicle immediately:** the system cannot manage the current driving situation.

**i** "Activation not possible, conditions unsuitable". The system refuses to activate cruise control, as the necessary conditions are not fulfilled.

### Stop & Go function

**(A)**  "To move off again, press the accelerator pedal or press the II button" (button 4).

The system has brought the vehicle to a complete stop.

Within 3 seconds, the vehicle gradually and automatically begins moving again. After 3 seconds, the driver must accelerate or press button 4 to move off again.

**!** While the vehicle is immobilised, the following recommendations apply:

- The driver should not leave the vehicle.
- Do not open the boot.
- Do not drop off or pick up passengers.
- Do not engage reverse gear.

**!** When moving off again, watch out for cyclists, pedestrians and animals, as they may not be detected properly.

## Operating limits

Cruise control operates by day and night, in fog or moderate rainfall.

Certain situations cannot be managed by the system and require driver intervention.

### Elements not detected by the system:

- Pedestrians, some cyclists, animals.
- Stationary vehicles (traffic jam, breakdown, etc.).

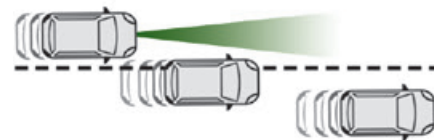

- Vehicles crossing your lane.

- Vehicles driving in the opposite direction.

**Situations in which the driver must pause the cruise control system:**

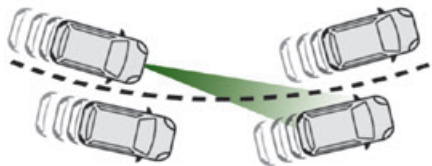

- Vehicles in a tight bend.
- When approaching a roundabout.

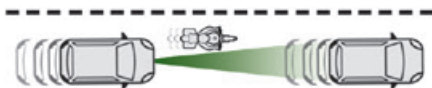

- When following a narrow vehicle.

**Situations in which the driver is prompted to immediately resume control:**

- Excessively sharp deceleration by the vehicle in front of you.

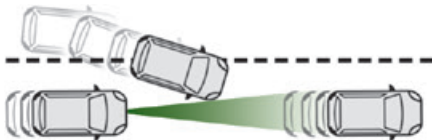

- When a vehicle cuts in sharply between your vehicle and the one in front.

- !** Pay particular attention:
- When motorcycles are present and when there are vehicles staggered across the traffic lane.
  - When entering a tunnel or crossing a bridge.

- !** If any of the following malfunctions occurs, do not use the system:
- Following an impact on the windscreen close to the camera or on the front bumper (versions with radar).
  - Brake lamps not working.

- !** If the vehicle has undergone any of the following modifications, do not use the system:
- Carrying long objects on roof bars.
  - Towing.
  - Front end of the vehicle modified (for example by adding long-range headlamps or painting the front bumper).

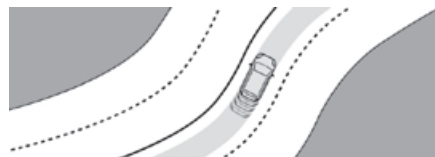

Using a camera located at the top of the windscreen, the system identifies lane markings and steers the vehicle inside this lane to keep it in the lateral position chosen by the driver. This function is primarily suitable for driving on motorways and main roads.

**Conditions for operation**

- Adaptive Cruise Control active.
- Traffic lane marked out by lines on both sides.
- ESC system operational.
- ASR system activated.
- No trailer detected.
- No 'space-saver' spare wheel in use.
- Vehicle not subject to strong lateral g-forces.
- Direction indicators not activated.

**Activation/Deactivation**



**Active Lane Keeping Assist**

Refer to the **General recommendations on the use of driving and manoeuvring aids.**



► With the Adaptive Cruise Control with Stop & Go function activated, press this button.

The action is confirmed by:

- The indicator lamp in the button lighting up green.
- The following symbol being displayed on the instrument panel.

The colour of the symbol on the instrument panel depends on the operating status of the system:



(grey colour)

One or more operating conditions is not met; the system is paused.



(green colour)

All operating conditions are met; the system is active.



(orange colour)

System malfunction.

If the driver no longer wishes to use the system for a while, they can deactivate it by pressing the button again.

The indicator lamp in the button goes off and the symbol disappears from the instrument panel.



The system status is saved when the ignition is switched off.

## Cruise control

The driver must hold the steering wheel properly. When cruise control is activated, the symbol is displayed in green: by small steering actions, the system directs the vehicle and keeps it in the position chosen by the driver, in the traffic lane.

This position is not necessarily the centre of the lane.

The driver can feel movements in the steering wheel.

The driver can change the position of the vehicle at any time, by turning the steering wheel.

When the driver feels that the vehicle's position is appropriate, whilst keeping hands on the steering wheel, they must release the pressure to let the system resume control of the steering, but the vehicle will not be automatically centred within the lane.

## Pausing/Suspending the system



The driver must act promptly if they believe that the traffic conditions or the state of the road surface require their intervention, by moving the steering wheel to temporarily suspend system operation. Any action on the brake pedal that results in cruise control being paused will also cause the system to be paused.



If the system detects that the driver is not holding the wheel firmly enough, it triggers a series of gradual alerts and then deactivates itself if there is no response from the driver.



If the function is suspended due to the prolonged release of the force holding the steering wheel, you must reactivate it by pressing the button again.

### Automatic pause













- Triggering of the ESC.
- Prolonged failure to detect one of the lane limit markings. In this case, the active lane departure warning function can take over, and the system will reactivate itself once the operating conditions are again met.



### In response to action by the driver: suspension

- Activation of the direction indicators.
- Travelling outside the lane limits.
- Too tight a grip on the steering wheel or dynamic action on the steering wheel.
- Action on the brake pedal (resulting in a pause until cruise control is reactivated) or accelerator pedal (suspension for as long as the pedal is depressed).
- Pausing of the cruise control.
- Deactivation of the ASR.

## Driving situations and related alerts

The tables below describe the displays associated with the main driving situations. The display of these alerts is not sequential.

Button indicator lamp	Cruise control thumbwheel	Symbols	Display	Comments
Off	CRUISE	 (grey)	 (grey)	Cruise control paused; lane positioning assist not active.
Off	CRUISE	 (green)	 (grey)	Cruise control active; lane positioning assist not active.
Green	CRUISE	 (green)	 (green)	Drive Assist Plus active, operates normally (correction is made at the steering wheel).
Green	CRUISE	 (grey)	 (grey)	Drive Assist Plus paused.
Green	CRUISE	 (green)/(grey)	 (grey)	Drive Assist Plus active; not all conditions required for lane positioning assist have been met.
Green	OFF or LIMIT	 (grey)	 (grey)	Cruise control not active; not all conditions required for lane positioning assist have been met.

Button indicator lamp	Cruise control thumbwheel	Symbols	Display	Comments
Green	CRUISE	 (green)/(grey)	 (grey)	Drive Assist Plus suspended: cruise control and lane positioning assist are suspended.

Messages	Driving situations
"Activate cruise control to use the lane positioning assist system"	Activation of lane positioning assist while cruise control is not active.
"Unsuitable conditions, Activation on stand-by"	Activation of lane positioning assist while not all conditions are met.
"Keep your hands on the steering wheel"	Prolonged driving without holding the steering wheel, holding it improperly or without applying any force.
"Hold the steering wheel"	Actual or imminent loss of lane positioning assist.
"Retake control"	Simultaneous loss of cruise control and lane positioning assist.

## Operating limits

**i** The Lane Keeping Assist system may issue an alert when the vehicle is travelling in a long straight lane on a smooth road surface even if the driver is holding the steering wheel properly.

The system may fail to operate or may produce unsuitable corrections to the steering in the following situations:

- Poor visibility (insufficient road lighting, snowfall, rain, fog).

- Dazzle (headlamps of an oncoming vehicle, low sun, reflections on a wet road surface, leaving a tunnel, alternating light and shade).
- Windscreen area in front of the camera being dirty, misted up, frost-covered, snow-covered, damaged or masked by a sticker.
- Lane markings eroded, partially hidden (snow, mud) or multiple (roadworks, surface joints).
- Travelling in a tight bend.
- Winding roads.
- Presence of a tarmac joint on the road.

**!** The system must not be activated in the following situations:

- Driving with a "space-saver" type spare wheel.
- When towing, especially with an unconnected or unapproved trailer.
- Poor weather conditions.
- Driving on slippery road surfaces (risk of aquaplaning, snow, ice).
- Driving on racing circuits.
- Driving on a rolling road.

## Malfunction



A system malfunction is indicated by the Service warning lamp coming on and this (orange) symbol, accompanied by an alert message and an audible signal.

## Active Lane Keeping Assistance

Refer to the **General recommendations on the use of driving and manoeuvring aids**.

Using a camera located at the top of the windscreen to identify lane markings on the road and at the edges of the road (depending on version), the system corrects the trajectory of the vehicle while alerting the driver if it detects a risk of unintentionally crossing a line or hard shoulder (depending on version).

This system is particularly useful on motorways and main roads.

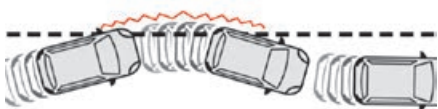

## Conditions for operation

- Vehicle speed between 40 and 112 mph (65 and 180 km/h).
- Road marked with a central dividing line.
- Steering wheel held in both hands.

- Direction indicators not activated.
- ESC system activated and operational.

**!** The system helps the driver only if there is a risk of the vehicle unintentionally wandering from the lane it is being driven in. It does not manage the safe driving distance, vehicle speed or brakes.

The driver must hold the steering wheel with both hands in a way that allows control to be maintained in circumstances where the system is not able to intervene (for example, if the central dividing line disappears).

## Operation

Once the system identifies a risk of the vehicle involuntarily crossing one of the lane markings detected or a lane limit (e.g. grass border), it makes the necessary trajectory correction to return the vehicle to its initial path.

The driver will notice a turning movement of the steering wheel.



This warning lamp flashes during trajectory correction.

**i** The driver can prevent the correction by keeping a firm grip on the wheel (during an avoiding manoeuvre, for example). The correction is interrupted immediately if the direction indicators are operated.

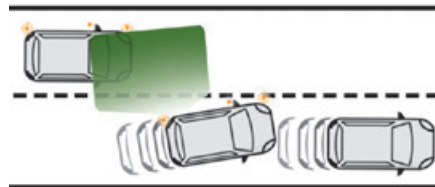

While the direction indicators are on and for a few seconds after switching them off, the system considers that any change of trajectory is intentional and no correction is triggered during this period.







However, with the Blind Spot Monitoring System activated, if the driver starts changing lanes and another vehicle is detected in the vehicle's blind spot, the system will correct the trajectory even though the direction indicators are on.

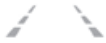
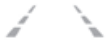

For more information on the **Blind Spot Monitoring System**, refer to the corresponding section.

**!** If the system detects that the driver is not holding the wheel firmly enough during an automatic correction of trajectory, it interrupts the correction. An alert is triggered to encourage the driver to take back control of the vehicle.

## Driving situations and related alerts

The table below describes the alerts and messages displayed in different driving situations. These alerts are not displayed sequentially.

Function status	Indicator lamp	Display and/or associated message	Comments
OFF		 (grey)	Function deactivated.
ON		 (grey)	System active, conditions not met: <ul style="list-style-type: none"> <li>– speed below 40 mph (65 km/h),</li> <li>– no lane marking recognised,</li> <li>– ASR/DSC systems deactivated or operation of ESC system triggered,</li> <li>– "sport" driving.</li> </ul>
ON		 (grey)	Automatic deactivation/standby of the function (for example, due to detection of a trailer or use of the "space-saver" spare wheel provided with the vehicle).
ON		 (green)	Lane marking detection. Speed above 40 mph (65 km/h).
ON		 (orange)/(green)	The system corrects the trajectory on the side where the risk of unintentional crossing is detected (orange line).

Function status	Indicator lamp	Display and/or associated message	Comments
ON	 	 (orange)/(green) "Hold the wheel"	<ul style="list-style-type: none"> <li>– If, while correcting the trajectory, the system determines that the correction will not be enough and that a solid line will be crossed (orange line): the driver is warned that they must provide additional trajectory adjustment.</li> <li>– If the steering wheel is not held properly, an audible warning sounds, accompanied by a message, until the trajectory correction is completed or the driver has grasped the steering wheel correctly.</li> </ul> <p>The duration of audible warnings will increase if multiple corrections are performed in quick succession. The warning will become continuous, persisting until the driver responds.</p>

## Operating limits

The system goes into standby automatically in the following cases:

- ESC deactivated or operation triggered.
- Speed below 43 mph (70 km/h) or greater than 112 mph (180 km/h),
- Electrical connection of a trailer.
- Use of a "space-saver" spare wheel detected (as detection is not immediate, deactivation of the system is recommended).
- Dynamic driving style detected, pressure on the brake or accelerator pedal.
- Driving where there are no lane markings.
- Activation of the direction indicators.
- Crossing the inside line on a bend.
- Driving in a tight corner.

– Inactivity by the driver detected during correction.

-  The following situations may interfere with the operation of the system or prevent it from working:
- Insufficient contrast between the road surface and the side of the road (e.g. shade).
  - Lane markings worn, hidden (snow, mud) or multiple (roadworks, etc.),
  - Running close to the vehicle in front (the lane markings may not be detected).
  - Roads that are narrow, winding.

### Risk of undesirable operation

We recommend deactivating the system in the following driving situations:

- Driving on damaged, unstable or very slippery (ice) road surfaces,
- Poor weather conditions.
- Driving on a speed circuit.
- Driving on a rolling road.

## Deactivation / Activation



► Press this button to deactivate / reactivate the system at any time.



Deactivation is signalled by the lighting of the indicator lamp in the button and this warning lamp in the instrument panel.

The system is **automatically reactivated** every time the ignition is switched on.

## Malfunction



In the event of a system malfunction, these warning lamps come on on the instrument panel, accompanied by an onscreen message and an audible signal. Have the system checked by a PEUGEOT dealer or a qualified workshop.

## Active Blind Spot Monitoring System

Refer to the **General recommendations on the use of driving and manoeuvring aids**.

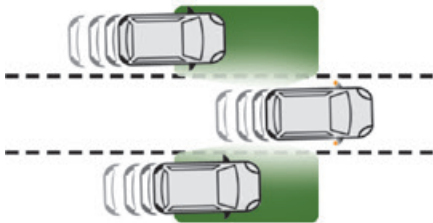

This system includes sensors, placed on the sides of the bumpers, and warns the driver of

the potentially dangerous presence of another vehicle (car, truck, motorcycle) in the blind spot areas of their vehicle (areas hidden from the driver's field of vision).

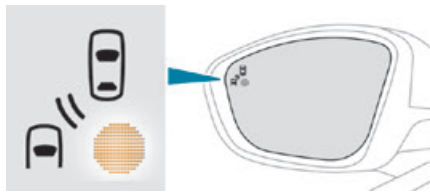

The warning is given by a fixed warning lamp that appears in the door mirror on the side in question:

- immediately, when being overtaken;
- after a delay of about one second, when overtaking a vehicle slowly.

In addition to this alert, a correction of trajectory will be felt if you attempt to cross a line with the direction indicator activated, to help you avoid a collision.

## Activation / Deactivation



It is set via the **Driving / Vehicle** touch screen menu.

When starting the vehicle, the warning lamp comes on in each mirror to indicate that the system is activated.

The state of the system stays in the memory when switching off the ignition.

**i** The system is automatically deactivated when towing with a towing device approved by PEUGEOT.

## Conditions for operation

- All vehicles are moving in the same direction and in adjacent lanes.
- The speed of the vehicle must be between 7 and 87 mph (12 and 140 km/h) for the alert and between 40 and 87 mph (65 and 140 km/h) for a correction of trajectory.
- The system must be activated to trigger a change of trajectory.
- When you overtake a vehicle with a speed difference of less than 6 mph (10 km/h).
- When another vehicle overtakes you with a speed difference of less than 16 mph (25 km/h).
- Traffic is flowing normally.
- Overtaking a vehicle over a certain period of time and the vehicle being overtaken remains in the blind spot.
- You are driving on a straight or slightly curved road.
- Your vehicle is not pulling a trailer, a caravan, etc.

## Operating limits

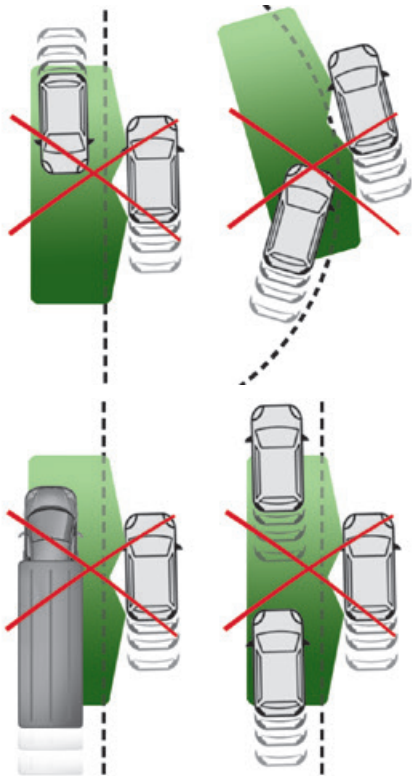

No alert will be given and no correction will be made in the following situations:

- In the presence of non-moving objects (parked vehicles, barriers, street lamps, road signs, etc.).
- Oncoming traffic.
- Driving on a winding road or a sharp corner.
- When overtaking or being overtaken by a very long vehicle (lorry, bus, etc.) which is both detected in the rear blind spot and present in the driver's front field of vision.
- When overtaking quickly.
- In very heavy traffic: vehicles detected in front and behind are confused with a lorry or a stationary object.
- If the Park Assist or Full Park Assist function is activated.

## Malfunction



If the event of a malfunction, this warning lamp comes on in the instrument panel, accompanied by the display of a message. Contact a PEUGEOT dealer or a qualified workshop to have the system checked.

- i** The system may suffer temporary interference in certain weather conditions (rain, hail, etc.). In particular, driving on a wet surface or moving from a dry area to a wet area can cause false alerts (for example, the presence of a fog of water droplets in the blind spot angle is interpreted as a vehicle). In bad or wintry weather, ensure that the sensors are not covered by mud, ice or snow.

Take care not to cover the warning zone in the door mirrors, or the detection zones on the front and rear bumpers with adhesive labels or other objects; they may hamper correct operation of the system.

## Active Safety Brake with Distance Alert and Intelligent emergency braking assistance

Refer to the **General recommendations on the use of driving and manoeuvring aids**.



This system:

- warns the driver that their vehicle is at risk of collision with the vehicle in front, a pedestrian or, depending on version, a cyclist.
- reduces the vehicle's speed to avoid a collision or limit its severity.

- i** The system also takes motorcyclists and animals into account; however, animals below 0.5 m tall and objects on the road are not necessarily detected.

This system is comprised of three functions:

- Distance Alert.
- Intelligent emergency braking assistance.



– Active Safety Brake (automatic emergency braking).

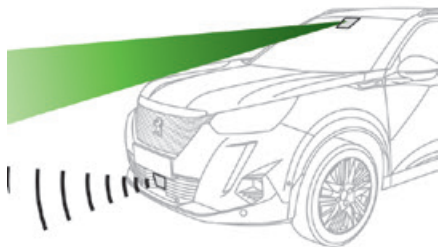

The vehicle has a multifunction camera located at the top of the windscreen and, depending on version, a radar located in the front bumper.

**!** This system does not avoid the need for vigilance on the part of the driver.

This system is designed to assist the driver and improve road safety.

It is the driver's responsibility to continuously monitor traffic conditions in accordance with applicable driving regulations.

**i** As soon as the system detects a potential obstacle, it prepares the braking circuit in case automatic braking is needed. This may cause a slight noise and a slight sensation of deceleration.

## Deactivation / Activation

By default, the system is automatically activated at every engine start.



It is set via the **Driving / Vehicle** touch screen menu.



Deactivation of the system is signalled by the illumination of this warning lamp, accompanied by the display of a message.

## Operating conditions and limits

Vehicle moving forward.

ESC system in working order.

ASR system activated.

Seat belts fastened for all passengers.

Stabilised speed on unwinding roads.

In the following cases, deactivating the system via the vehicle's configuration menu is advised:

- Towing a trailer.
- Carrying long objects on roof bars.
- Vehicles with snow chains fitted.
- Before using an automatic car wash, with the engine running.
- Before placing the vehicle on a rolling road in a workshop.
- Towed vehicle, engine running.
- Following an impact to the windscreen close to the detection camera.



The system is automatically deactivated after the use of certain types of "space-saver" type spare wheel (smaller

diameter) is detected, or if a fault with brake pedal switch or at least two brake lamps is detected.



It can be dangerous to drive if the brake lamps are not in perfect working order.



It is possible that warnings are not given, are given too late or seem unjustified. The driver must always stay in control of the vehicle and be prepared to react at any time to avoid an accident.



After an impact, the function automatically stops operating. Contact a PEUGEOT dealer or a qualified workshop to have the system checked.

## Distance Alert

This function warns the driver that their vehicle is at risk of a collision with the vehicle in front, or a pedestrian or cyclist present in their traffic lane.

### Modifying the alert trigger threshold

This trigger threshold determines the sensitivity with which the function warns of the risk of collision.



The threshold is set via the **Driving / Vehicle** touch screen menu.

- ▶ Select one of the three pre-defined thresholds: "Far", "Normal" or "Close".

The last threshold selected is memorised when the ignition is switched off.

## Operation

Depending on the degree of risk of collision detected by the system and the alert trigger threshold chosen by the driver, several different levels of alert may be triggered and displayed in the instrument panel.

The system takes account of the vehicle dynamics, the speed of your vehicle and the one in front, the environmental conditions and the operation of the vehicle (actions on the pedals, the steering wheel, etc.) to trigger the alert at the best moment.



**Level 1 (orange):** visual alert only, indicating that the vehicle in front is very close.

The message **"Vehicle close"** is displayed.



**Level 2 (red):** visual and audible alert, indicating that a collision is imminent.

The message **"Brake!"** is displayed.

**Level 3:** in some cases, a vibration alert in the form of micro-braking can be given, confirming the risk of collision.

**i** Where the speed of your vehicle is too high approaching another vehicle, the first level of alert may not be displayed: the level 2 alert may be displayed directly.

**Important:** the level 1 alert is not displayed when there is a stationary obstacle or when

the **"Close"** trigger threshold has been selected.

## Intelligent emergency braking assistance

If the driver brakes, but not sufficiently to avoid a collision, this system will supplement the braking, within the limits of the laws of physics.

This assistance will only be provided if the driver presses the brake pedal.

## Active Safety Brake



This function, also called automatic emergency braking, intervenes following the alerts if the

driver does not react quickly enough and does not operate the vehicle's brakes. It aims to reduce the speed of impact or avoid a collision where the driver fails to react.

## Operation

The system operates subject to the following conditions:

- The vehicle's speed does not exceed 37 mph (60 km/h) when a pedestrian is detected.
- The vehicle's speed does not exceed 50 mph (80 km/h) when a stationary vehicle or a cyclist is detected.
- The vehicle's speed is between 6 mph and 53 mph (10 km/h and 85 km/h) (versions with camera only) or 87 mph (140 km/h) (versions with camera and radar) when a moving vehicle is detected.



This warning lamp immediately flashes (for approximately 10 seconds) when the function acts on the vehicle's braking.

With an automatic gearbox or drive selector, in the event of automatic emergency braking until the vehicle comes to a complete stop, keep the brake pedal pressed down to prevent the vehicle from moving off again.

With a manual gearbox, in the event of automatic emergency braking until the vehicle comes to a complete stop, the engine may stall.

**i** The driver can maintain control of the vehicle at any time by firmly turning the



steering wheel and/or firmly depressing the accelerator pedal.

**i** The brake pedal may vibrate slightly while the function is operating. If the vehicle comes to a complete stop, automatic braking is maintained for 1 to 2 seconds.

## Malfunction

 In the event of a system malfunction, this warning lamp comes on on the instrument panel, accompanied by an onscreen message and an audible signal.

Contact a PEUGEOT dealer or a qualified workshop to have the system checked.

  If these warning lamps come on after the engine has been switched off and then restarted, contact a PEUGEOT dealer or a qualified workshop to have the system checked.

## Distraction detection

Refer to the **General recommendations on the use of driving and manoeuvring aids**.

Take a break in case of feeling tired or at least every 2 hours.

The function comprises the "Driver Attention Alert" system combined with the "Driver Attention Alert by camera" system.

**!** These systems are in no way designed to keep the driver awake or to prevent the driver from falling asleep at the wheel. It is the driver's responsibility to stop if feeling tired.

## Activation / Deactivation



It is set via the **Driving / Vehicle** touch screen menu.

The state of the system stays in the memory when the ignition is switched off.

## Driver Attention Alert



The system triggers an alert as soon as it detects that the driver has not taken a break after two hours of driving at a speed above 40 mph (65 km/h).

This alert is issued via the display of a message encouraging the driver to take a break, accompanied by an audible signal.

If the driver does not follow this advice, the alert is repeated hourly until the vehicle is stopped. The system resets itself if one of the following conditions is met:

- With the engine running, the vehicle has been stationary for more than 15 minutes.
- The ignition has been switched off for a few minutes.
- The driver's seat belt is unfastened and their door is opened.

**i** As soon as the speed of the vehicle drops below 40 mph (65 km/h), the system goes into standby. The driving time is counted again once the speed is above 40 mph (65 km/h).

## Driver Attention Alert by camera

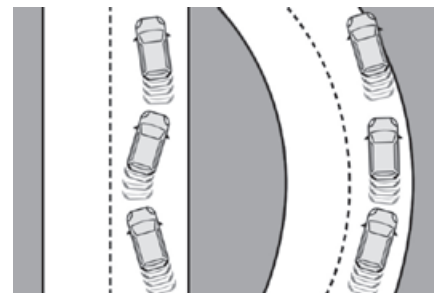

 Using a camera placed at the top of the windscreen, the system assesses the driver's level of vigilance, fatigue or distraction by identifying variations in trajectory compared to the lane markings.

This system is particularly suited to fast roads (speed higher than 40 mph (65 km/h)).

At a first-level alert, the driver is warned by the "Take care!" message, accompanied by an audible signal.

After three first-level alerts, the system triggers a further alert with the message "Dangerous

**driving: take a break"**, accompanied by a more pronounced audible signal.

**i** In certain driving conditions (poor road surface or strong winds), the system may give alerts independent of the driver's level of vigilance.

- !** The following situations may interfere with the operation of the system or prevent it from working:
- lane markings absent, worn, hidden (snow, mud) or multiple (roadworks);
  - close to the vehicle ahead (lane markings not detected);
  - roads that are narrow, winding, etc.

## Parking sensors

Refer to the **General recommendations on the use of driving and manoeuvring aids**.

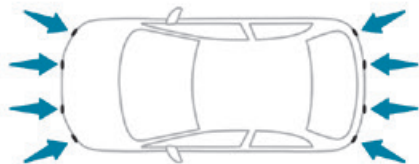

Using sensors located in the bumper, this system signals the proximity of obstacles (e.g. pedestrian, vehicle, tree, barrier) present in their field of detection.

## Rear parking sensors

The system is switched on by engaging reverse gear, as confirmed by an audible signal.

The system is switched off when you come out of reverse gear.

### Audible assistance



The system signals the presence of obstacles within the sensors' detection zone.

The proximity information is given by an intermittent audible signal, the frequency of which increases as the vehicle approaches the obstacle.

When the distance between the vehicle and the obstacle becomes less than about thirty centimetres, the audible signal becomes continuous.

The sound emitted by the speaker (right or left) indicates the side on which the obstacle is located.

### **i** Adjusting the audible signal

 With PEUGEOT Connect Radio or PEUGEOT Connect Nav, pressing

this button opens the window for adjusting the volume of the audible signal.

## Visual assistance



This supplements the audible signal by displaying bars on the screen that represent the distance between the obstacle and the vehicle (white: more distant, orange: close, red: very close).

When the obstacle is very close, the "Danger" symbol is displayed on the screen.

## Front parking sensors

Supplementing the rear parking sensors, the front parking sensors are triggered when an obstacle is detected in front and the speed of the vehicle is still below 6 mph (10 km/h).

Front parking sensor operation is suspended if the vehicle stops for more than three seconds in forward gear, if an obstacle is no longer detected or the vehicle speed exceeds 6 mph (10 km/h).

**i** The sound emitted by the speaker (front or rear) locates the obstacle relative to the vehicle, in front or behind it.

## Side parking sensors



Using four additional sensors located on the sides of the bumpers, the system records the position of obstacles during the manoeuvre and indicates them when they are located alongside the vehicle.

**!** Only fixed obstacles are indicated correctly. Moving obstacles detected at the beginning of the manoeuvre may be indicated mistakenly, while moving obstacles that appear alongside the vehicle but were not previously recorded will not be indicated.

**!** Objects memorised during the manoeuvre will no longer be stored after switching off the ignition.

## Deactivation / Activation



It is set via the **Driving / Vehicle** touch screen menu.

The state of the system stays in the memory when the ignition is switched off.



**i** The rear parking sensors system will be deactivated automatically if a trailer or bicycle carrier is connected to a towing device installed in accordance with the manufacturer's recommendations. In this case, the outline of a trailer is displayed at the rear of the image of the vehicle.

The parking sensors are deactivated while the Park Assist and Full Park Assist functions are measuring a space. For more information on the **Park Assist** or the **Full Park Assist**, refer to the corresponding section.

**i** When the vehicle is started, the visual and audible aids will be available after the touch screen has started up.

## Operating limits

If the boot is heavily loaded, the vehicle may tilt, affecting distance measurements.

## Malfunction



In the event of a malfunction when shifting to reverse, one of these warning lamps comes on on the instrument panel, accompanied by the display of a message and an audible signal (short beep). Contact a PEUGEOT dealer or a qualified workshop to have the system checked.

## Visiopark 1

Refer to the **General recommendations on the use of driving and manoeuvring aids**.

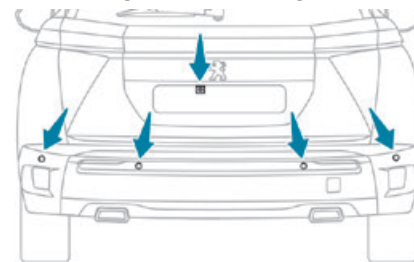

As soon as reverse gear is engaged with the engine running, this system displays views of your vehicle's close surroundings on the touch screen using a camera located at the rear of the vehicle.

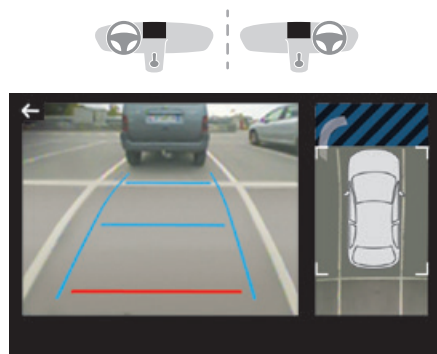

The screen is divided into two parts with a contextual view and a view from above the vehicle in its close surroundings.

The parking sensors supplement the information on the view from above the vehicle.

Various contextual views may be displayed:

- Standard view.
- 180° view.
- Zoom view.

AUTO mode is activated by default.

In this mode, the system chooses the best view to display (standard or zoom).

You can change the type of view at any time during a manoeuvre.

The system status is not saved when the ignition is switched off.

## Principle of operation

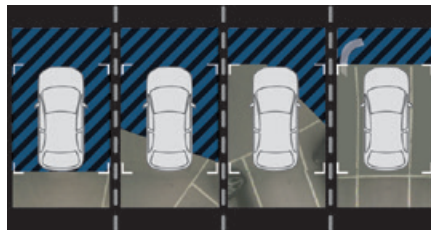

Using the rear camera, the vehicle's close surroundings are recorded during manoeuvres at low speed.

An image from above your vehicle in its close surroundings is reconstructed (represented between the brackets) in real time and as the manoeuvre progresses.

It facilitates the alignment of your vehicle when parking and allows obstacles close to the vehicle to be seen. It is automatically deleted if the vehicle remains stationary for too long.

## Rear vision



To activate the camera, located on the tailgate, engage reverse and keep the speed of the vehicle below 6 mph (10 km/h).

The system is deactivated:

- Automatically, at speeds above approximately 12 mph (20 km/h),
- Automatically, if the tailgate is opened.
- When changing out of reverse gear.
- By pressing the white arrow in the upper-left corner of the touch screen.

## AUTO mode

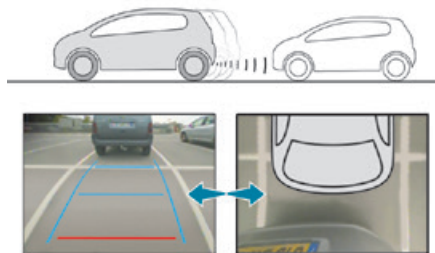

This mode is activated by default. Using sensors in the rear bumper, the automatic view changes from the rear view (standard) to the view from above (zoom) as an obstacle is approached at the level of the red line (less than 30 cm) during a manoeuvre.

## Standard view

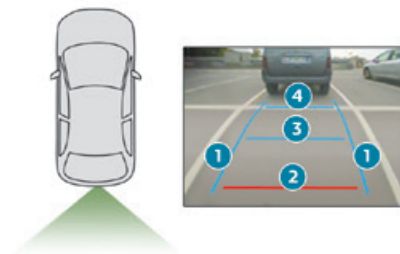

The area behind the vehicle is displayed on the screen.

The blue lines **1** represent the width of your vehicle, with the mirrors unfolded; their direction changes according to the position of the steering wheel.

The red line **2** represents a distance of 30 cm from the rear bumper; the two blue lines **3** and **4** represent 1 m and 2 m, respectively.

This view is available with AUTO mode or in the view selection menu.

## Zoom view

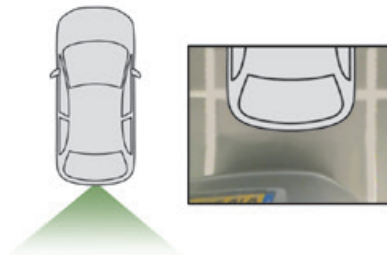

The camera records the vehicle's surroundings during the manoeuvre in order to create a view from above the rear of the vehicle in its near surroundings, allowing the vehicle to be manoeuvred around nearby obstacles. This view is available with AUTO mode or in the view selection menu.

**i** Obstacles may appear further away than they actually are.

It is important to monitor the sides of the vehicle during the manoeuvre, using the mirrors.

Parking sensors also provide additional information about the area around the vehicle.

## 180° view

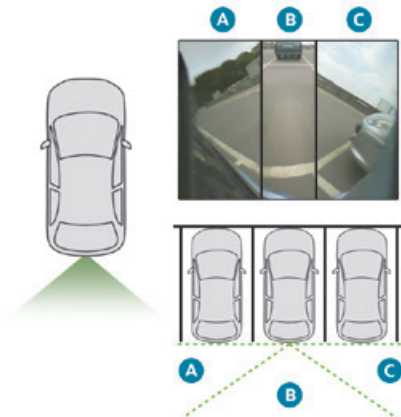

The 180° view facilitates reversing out of a parking space, making it possible to see the approach of vehicles, pedestrians and cyclists. This view is not recommended for carrying out a complete manoeuvre.

It features 3 areas: left **A**, centre **B** and right **C**.

This view is only available via the view selection menu.

## Park Assist

Refer to the **General recommendations on the use of driving and manoeuvring aids**.

This system provides active parking assistance: it detects a parking space and then steers in the appropriate direction to park in the space while the driver controls the driving direction, gear changes, acceleration and braking.

To help the driver monitor the manoeuvre, the system automatically triggers the display of Visiopark 1 and activates the parking sensors. The system measures the available parking spaces and calculates the distances to obstacles using ultrasonic sensors built into the front and rear bumpers of the vehicle.

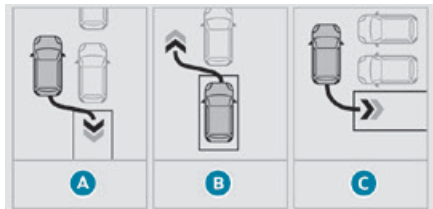

The system assists with the following manoeuvres:

- A.** Entering a "parallel" parking space
- B.** Leaving a "parallel" parking space
- C.** Entering a "bay" parking space

## Operation

- ▶ When approaching a parking area, reduce the speed of your vehicle to 19 mph (30 km/h) or less.

### Activating the function



The function is activated in the **Vehicle / Driving** touch screen menu.

Select **"Park Assist"**.



Activating the function deactivates the Blind Spot Monitoring System.



You can deactivate the function at any time until the parking space entry or exit manoeuvre begins, by pressing the arrow located in the top left-hand corner of the display page.

### Selecting the type of manoeuvre

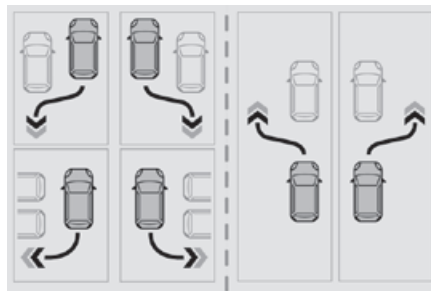

A manoeuvre selection page is displayed on the touch screen: by default, the "Entry" page if the vehicle has been running since the ignition was switched on, otherwise, the "Exit" page.

- ▶ Select the type and side of the manoeuvre to activate the parking space search. The selected manoeuvre can be changed at any time, even while searching for an available space.



This indicator lamp comes on to confirm the selection.

### Parking space search

- ▶ You should drive at a distance of between 0.50 m and 1.50 m from the row of parked vehicles, without ever exceeding 19 mph (30 km/h), until the system finds an available space.

The parking space search stops over this limit. The function automatically deactivates once the vehicle speed exceeds 31 mph (50 km/h).



For "parallel" parking, the space must at a minimum be equal to the length of your vehicle plus 0.60 m.

For "bay" parking, the width of the space must be equal to the width of your vehicle plus 0.70 m.



If the parking sensors function has been deactivated in the **Driving/Vehicle** menu of the touch screen, it will be automatically reactivated when the system is activated.





When the system finds an available space, "OK" is displayed on the parking view, accompanied by an audible signal.

### Preparing for the manoeuvre

► Move very slowly until the request to stop the vehicle is displayed: "**Stop the vehicle**", accompanied by the "**STOP**" sign and an audible signal.

Once the vehicle has stopped, an instructions page is displayed on the screen.

► To prepare for the manoeuvre, follow the instructions.

The start of the manoeuvre is indicated by the message "**Manoeuvre under way**", accompanied by an audible signal.

Reversing is indicated by this message:

"**Release the steering wheel, reverse**".

Visiopark 1 and the parking sensors are automatically activated to help you monitor

your vehicle's close surroundings during the manoeuvre.

### During the manoeuvre

The system controls the vehicle's steering. It gives instructions on the manoeuvring direction when starting "parallel" entry and exit parking manoeuvres, and for all "bay" entry manoeuvres. There instructions are displayed as a symbol accompanied by a message:



"Reverse".



"Go forwards".

The manoeuvring status is indicated by these symbols:



Manoeuvre in progress (green).



Manoeuvre cancelled or finished (red) (the arrows indicate that the driver must resume control of the vehicle).

The maximum speeds during manoeuvres are indicated by these symbols:



5 mph or 7 km/h, for parking space entry.



3 mph or 5 km/h, for parking space exit.

! During manoeuvring phases, the steering wheel performs rapid turns: do not hold the steering wheel or put your hands between the spokes of the steering wheel. Watch out for any objects that could interfere with the

manoeuvre (loose clothing, scarf, tie, etc.). Risk of injury!

It is the driver's responsibility to constantly monitor the traffic, especially vehicles coming towards you.

The driver should check that no objects or people are obstructing the vehicle's path.

**i** The images from the camera(s) displayed on the touch screen may be distorted by the terrain.

In shady areas, or in inadequate sunlight or lighting conditions, the image may be darkened and with lower contrast

The manoeuvre can be permanently interrupted at any time, either by the driver or automatically by the system.

Interruption by the driver:

- taking over control of the steering.
- activating the direction indicator lamps on the opposite side to that of the manoeuvre.
- unfastening the driver's seat belt.
- switching off the ignition.

Interruption by the system:

- vehicle exceeding the speed limit of 5 mph (7 km/h) during parking space entry manoeuvres, or 3 mph (5 km/h) during parking space exit manoeuvres.
- activation of anti-slip regulation on a slippery road.
- opening of a door or the boot.
- engine stall.

- system malfunction.
- after 10 manoeuvres to enter or exit a parallel parking space and after 7 manoeuvres to enter a parking bay.

Interrupting the manoeuvre automatically deactivates the function.

The manoeuvre symbol is displayed in red, accompanied by the **"Manoeuvre cancelled"** message on the touch screen.

A message prompts the driver to take back control of the vehicle.



The function is deactivated after a few seconds; this warning lamp goes off and the function returns to the initial display.

## End of the parking space entry or exit manoeuvre

The vehicle stops as soon as the manoeuvre is completed.

The manoeuvring symbol is displayed in red accompanied by the message **"Manoeuvre completed"** on the touch screen.



Deactivation of the function is confirmed by this indicator lamp going off, accompanied by an audible signal.

If entering a parking space, the driver may be required to complete the manoeuvre.

## Operating limits

- The system may suggest an inappropriate parking space (parking prohibited, work in progress with damaged road surface, location alongside a ditch, etc.).

- The system may indicate that a space has been found but will not offer it because of a fixed obstacle on the opposite side of the manoeuvre, which would not allow the vehicle to follow a trajectory required for parking.
- The system may indicate that a space has been found but the manoeuvre will not be triggered, because the width of the lane is insufficient.
- The system is not designed for performing the parking manoeuvre on a sharp bend.
- The system does not detect spaces that are much larger than the vehicle itself or that are delimited by obstacles that are too low (pavements, studs, etc.) or too thin (trees, posts, wire fences, etc.).
- If the boot is heavily loaded, the tilt of the vehicle towards the rear may interfere with the distance measurements.



Do not use the function under the following exterior conditions:

- Alongside a soft shoulder (e.g. ditch) or quay or on the edge of a drop.
- When the road surface is slippery (e.g. ice).



If any of the following malfunctions occurs, do not use the system:

- If a tyre is under-inflated.
- If one of the bumpers is damaged.
- If one of the cameras is faulty.



If the vehicle has undergone any of the following modifications, do not use the function:

- When carrying an object extending beyond the dimensions of the vehicle (ladder on the roof bars, bicycle carrier on the tailgate, etc.).
- With a non-approved towball in place.
- With snow chains fitted.
- When driving on a small-diameter or "space-saver" type spare wheel.
- When the wheels fitted are a different size from the original ones.
- After modifying one or both bumpers (added protection).
- If the sensors have been repainted other than by the PEUGEOT dealer network.
- With sensors not approved for the vehicle.

## Malfunctions



When the function is not activated, the temporary flashing of this indicator lamp and an audible signal indicate a system malfunction.

If the malfunction occurs while the system is in use, the indicator lamp goes off.



If the parking sensor malfunction occurs during use, indicated by one of these warning lamps coming on, it causes the function to deactivate.

In the event of a malfunction, have the system checked by a PEUGEOT dealer or a qualified workshop.



In the event of a power steering malfunction, this warning lamp is displayed on the instrument panel, accompanied by a warning message.

You must stop as soon as it is safe to do so. Contact a PEUGEOT dealer or a qualified workshop.

## Full Park Assist

Refer to the **General recommendations on the use of driving and manoeuvring aids**.

This system provides active parking assistance for vehicles fitted with the EAT8 automatic gearbox or a gear selector: it detects a free "parallel" or "bay" parking space and then operates the vehicle, parking it with no need for driver intervention. It also allows you to drive out of a "parallel parking" space automatically. The system controls the steering, direction, acceleration and braking. The system measures the available parking spaces and calculates the distances to obstacles using 12 ultrasonic sensors built into the front and rear bumpers of the vehicle.

To help the driver monitor the successful completion of the manoeuvre, the system automatically displays the Visiopark 1 and activates the parking sensors.

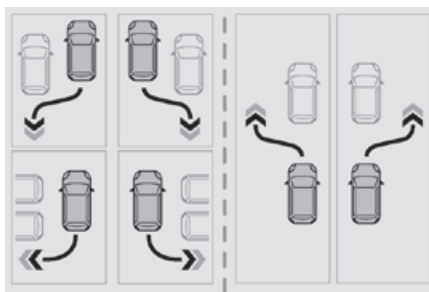

**To initiate parking assistance when approaching a parking area:**

- ▶ Reduce the speed of the vehicle to a maximum of 19 mph (30 km/h).

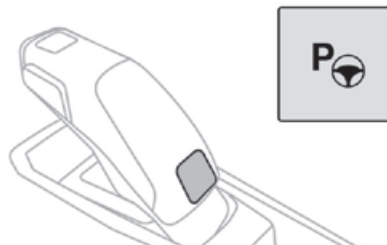

- ▶ Press the button on the gear selector or, on the touch screen, select **Driving / Vehicle > Full Park Assist**.



Activating the system deactivates Blind Spot Monitoring System.

### Sequence

Once the system is activated, the following steps will be performed successively:

- Select the type of manoeuvre via the touch screen.
- Search for an available space.
- Prepare for the manoeuvre.
- Perform the manoeuvre.
- Finalise the manoeuvre.



It is possible to deactivate the system at any time until the start of the manoeuvre, by pressing the red arrow in the upper left corner of the screen.



Full Park Assist is not always able to react automatically and appropriately due to the performance limits inherent to the system.

The manoeuvre remains the responsibility of the driver, who must not leave the driving position and must never try to lock the system control button.

The driver's seat belt must remain fastened during the manoeuvre.

## Choice of the type of manoeuvre and search for space

Depending on whether the vehicle has been driven or not since the ignition was switched on,

the function proposes the entry to or exit from a parking space on the touch screen.

- ▶ Select the type and side of the manoeuvre to activate the parking space search.

 Illumination of this lamp confirms activation.

It is possible to change the type of manoeuvre at any time, including during the available space search phase.

- ▶ Drive at a distance of 0.50 to 1.50 m from the row of parked vehicles, not exceeding 19 mph (30 km/h), until the system finds an available space (indicated by **OK** on the display and an audible signal).

- i** For "parallel" parking, the space must at least equal to the length of your vehicle plus 1 m.
- For "bay" parking, the space must at least equal to the width of your vehicle plus 0.70 m.

## Preparing for the manoeuvre

- ▶ Move very slowly until the request to stop the vehicle and the **"STOP"** sign are displayed, accompanied by an audible signal.
- Once the vehicle has stopped, an instructions page is displayed on the screen.
- ▶ To prepare for the manoeuvre, you must fulfil all of these instructions.

 This symbol will be displayed automatically when the instruction has been applied.

When all instructions have been validated, a new screen is displayed, indicating that you can undertake the manoeuvre.

 ▶ To undertake the manoeuvre, press this button.

- ▶ While holding down the button, gradually release the brake pedal.

**!** The button must be held down throughout the manoeuvre.

The start of the manoeuvre is indicated by the display of a screen with the message **"Manoeuvre under way"**, accompanied by an audible signal.

Visiopark 1 and the parking sensors are automatically activated to help you monitor the immediate area around your vehicle during the manoeuvre.

## Performing the manoeuvre

As soon as the driver releases the brake pedal, the system automatically takes control of choosing the travel direction, forwards or reverse, acceleration, braking and the steering direction.

The manoeuvring status is indicated by these symbols:

 Manoeuvre in progress.

 Manoeuvre interrupted.

 Manoeuvre completed or abandoned (white arrows indicate that the driver must take back control of their vehicle).

The direction of the manoeuvre is indicated by these symbols:

 Forward gear.

 Reverse gear.

The central arrow is green whilst the vehicle is moving, or white to indicate the next manoeuvring direction.

**!** Throughout the whole manoeuvre, indicated by the green **"AUTO"** symbol, the driver must hold the selector button down.

**!** During manoeuvring phases, the steering wheel performs rapid turns: do not hold the steering wheel or put your hands between the spokes of the steering wheel. Watch out for any objects that could interfere with the manoeuvre (loose clothing, scarf, tie, etc.). Risk of injury!

**i** If the vehicle slows down significantly, the brake lamps may come on.

## Pausing/resuming the manoeuvre

The manoeuvre can be interrupted temporarily at any time, either automatically by the system if

an obstacle is detected, or by driver action. If the driver notices a hazard, they may also interrupt the manoeuvre permanently.

To suspend the manoeuvre, the driver can:

- Release the function control button.
- Depress the brake pedal.
- Resume control of the steering.
- Change the gearbox status (except changing to **P**).

The vehicle is immediately immobilised if the manoeuvre is suspended.



This is confirmed by the display of this symbol, accompanied by the message "**Manoeuvre suspended**".

#### Resuming the manoeuvre after resolving the conditions for suspending it:

- ▶ Release all controls (brake pedal, function control button, steering wheel, etc.).
- ▶ Press the function control button again.

#### Permanent interruption after suspending the manoeuvre:

- ▶ Depress the brake pedal and engage a gear.

#### Abandoning the manoeuvre

The manoeuvre is abandoned in the following situations:

- No action by the driver within 30 seconds of the manoeuvre being suspended.
- Intentional application of the parking brake.
- Gearbox mode **P** engaged by the driver.
- Driver's seat belt unfastened.
- Opening of a door or the boot.

– Activation of the direction indicator lamps on the opposite side to that of the manoeuvre.

- In certain cases, when a wheel of the vehicle hits a pavement or a low obstacle.
- Triggering of anti-slip regulation on a slippery road.
- Engine stalling.
- Sudden appearance in the field of the manoeuvre of an obstacle not detected by the system before the manoeuvre was started, with the obstacle remaining for more than 30 seconds.

- After 10 manoeuvres to enter or exit a "parallel" parking space and after 7 manoeuvres to enter a "bay" parking space,
  - System malfunction during the manoeuvre.
- Abandoning the manoeuvre immediately triggers the vehicle's brakes and automatically deactivates the function.



This symbol is displayed, accompanied by the message "**Manoeuvre abandoned**" on the touch screen.

A message prompts the driver to take back control of the vehicle.



The function is deactivated after a few seconds; this indicator lamp goes off on the instrument panel and the initial display is resumed.

The system automatically engages gearbox mode **P** after 4 seconds.

## End of manoeuvre

The vehicle stops as soon as the manoeuvre is completed.



This symbol is displayed, accompanied by the message "**Manoeuvre completed**" on the touch screen.



When the function is deactivated, this indicator lamp on the instrument panel goes off and the original display is restored.

- If entering a parking space, the driver may be required to complete the manoeuvre. The gearbox changes to **P** 4 seconds after completion of the manoeuvre.
- When exiting a parking space, the gearbox changes to **N** when the manoeuvre is complete. A message and symbols prompt the driver to take back control of the vehicle. The gearbox automatically changes to mode **P** if no action is taken by the driver within 30 seconds.

## Operating limits

- The system may suggest an inappropriate parking space (parking prohibited, work in progress with damaged road surface, location alongside a ditch, etc.).
- The system may indicate that a space has been found but will not offer it because of a fixed obstacle on the opposite side of the manoeuvre, which does not allow the vehicle to follow the trajectory required for parking.

- The system may indicate that a space has been found but the manoeuvre will not be triggered because the width of the lane is insufficient.
- The system is not designed to perform parking manoeuvres on a steep slope or on a sharp curve.
- The system does not detect spaces that are much larger than the vehicle itself or that are delimited by obstacles that are too low (pavements, studs, etc.) or too thin (trees, posts, wire fences, etc.).
- The system may be impaired by incorrect inflation of the vehicle's tyres.
- The tilting of the vehicle if the boot is heavily loaded can affect the distance measurements.



Do not use the function under the following exterior conditions:

- Alongside a soft shoulder (ditch) or quay or on the edge of a drop.
- When the road surface is slippery (ice).



Do not use the function in the presence of one of the following malfunctions:

- If a tyre is under-inflated.
- If one of the bumpers is damaged.
- If one of the cameras is faulty.
- If the brake lamps are not working.



Do not use the function if the vehicle has been subject to one of the following modifications:

- When carrying an object extending beyond the dimensions of the vehicle (ladder on the roof bars, bicycle carrier on the tailgate, etc.).
- With a non-approved towball in place.
- With snow chains fitted.
- When driving on a small-diameter or "space-saver" type spare wheel.
- When the wheels fitted are a different size from the original ones.
- After modifying one or both bumpers (added protection).
- If the sensors have been repainted outside the PEUGEOT dealer network.
- With sensors not approved for the vehicle.



In the event of a power steering malfunction, this warning lamp is displayed on the instrument panel, accompanied by a message.

You must stop as soon as it is safe to do so. Contact a PEUGEOT dealer or a qualified workshop.

## Malfunctions



When the function is not activated, the temporary flashing of this warning lamp and an audible signal indicate a Full Park Assist malfunction.

If the malfunction occurs while the system is in use, the warning lamp goes off.



If a parking sensor malfunction, indicated by one of these warning lamps coming on, occurs during Full Park Assist use, the function is deactivated.

Contact a PEUGEOT dealer or a qualified workshop.

Automobiles PEUGEOT declares, in accordance with the provisions of the European legislation (Directive 2000/53) relating to End-of-Life Vehicles, that it achieves the objectives set by this legislation and that recycled materials are used in the manufacture of the products that it sells.  
Reproduction or translation of all or part of this document is prohibited without written authorisation from Automobiles PEUGEOT.



**PEUGEOT**



AUTOMOBILES PEUGEOT - Siège Social : 7, rue Henri Sainte-Claire Déville - 92500 RUEIL-MALMAISON  
<http://www.peugeot.com>

Société anonyme au capital de 172.711.770 € - R.C.S.NANTERRE : 552 144 503

Printed in the EU  
11-19

[www.peugeot.com](http://www.peugeot.com)



**ANG. 19P24.0040**